



Appendix B3
Mainline Plan and Profile



BUSCONNECTS DUBLIN CORE BUS CORRIDORS INFRASTRUCTURE WORKS

KIMMAGE TO CITY CENTRE CORE BUS CORRIDOR SCHEME

DRAWING SERIES NUMBER(S)	DRAWING SERIES DESCRIPTION
BCIDD-ROT-GEO_IX-0011_ML_00-DR-CR-0001	KIMMAGE TO CITY CENTRE CORE BUS CORRIDOR SCHEME. MAINLINE PLAN & PROFILES. COVER SHEET
BCIDD-ROT-GEO_KP-0011_ML_00-DR-CR-0001	KIMMAGE TO CITY CENTRE CORE BUS CORRIDOR SCHEME. MAINLINE PLAN & PROFILES. KEYPLAN
BCIDD-ROT-GEO_HV-0011_ML_00-DR-CR-0001-0011	KIMMAGE TO CITY CENTRE CORE BUS CORRIDOR SCHEME. MAINLINE PLAN & PROFILES.
BCIDD-ROT-GEO_HV-0011_SR_00-DR-CR-0001-0002	KIMMAGE TO CITY CENTRE CORE BUS CORRIDOR SCHEME. SIDEROAD PLAN & PROFILES.
BCIDD-ROT-GEO_HV-0011_SR_00-DR-CR-0011	KIMMAGE TO CITY CENTRE CORE BUS CORRIDOR SCHEME. SIDEROAD PLAN & PROFILES.

C:\projects\busconnects\dublin\kimmage\cover\sheet\BCIDD-ROT-GEO_IX-0011_ML_00-DR-CR-0001.dwg

Disclaimer
 a. © National Transport Authority (NTA) 2022. This drawing is confidential and the copyright in it is owned by NTA. This drawing must not be either loaned, copied or otherwise reproduced in whole or in part or used for any purpose without the prior permission of NTA.
 b. This drawing is to be used for the design element identified in the titleblock. Other information shown is to be considered indicative only. The drawing is to be read in conjunction with all other relevant design drawings.
 c. O.S. data used for plans are printed under © Ordnance Survey Ireland Government of Ireland. All rights reserved. Licence Number 2022/OSI_NMA_180 National Transport Authority. All elevations are in metres and relate to OSI Geoid Model (OSGM15) Mean Head. All Co-ordinates are in Irish Transverse Mercator Grid (ITM) as defined by OSI active local GPS station.
 d. Information concerning the position of apparatus shown on this drawing is based on drawings supplied by the utility owners and/or the utility works contractor, whilst every care has been taken in the preparation of this drawing, positions should be taken as approximate and are intended for general guidance only and no representation is made by the NTA as to the accuracy, completeness, sufficiency or otherwise of this drawing and the position of the apparatus. The information contained herein does not purport to be comprehensive or final as the apparatus is subject to being altered and/or superceded. Recipients should not rely on this information. Any liabilities are hereby expressly disclaimed.
 e. The information contained herein has been provided by the NTA but does not purport to be comprehensive or final. Recipients should not rely on the information. Neither the NTA nor any of its directors, officers, employees, agents, stakeholders or advisers make any representation or warranty as to, or accept any liability or responsibility in relation to, the adequacy, accuracy, reasonableness or completeness of the information provided as part of this document or any matter on which the information is based (including but not limited to loss or damage arising as a result of reliance by recipients on the information or any part of it). Any liabilities are hereby expressly disclaimed.

Project Ireland 2040
 Building Ireland's Future

Rev	Date	Drn	Chk'd	App'd	Description
M01	FEB 2023	CG	SMG	SMG	ISSUE FOR PHASE 4: PLANNING

Client NTA Údarás Náisiúnta Iompair National Transport Authority		Engineering Designer ROD TYP SA R. ROUGHAN & O'DONOVAN		
Date FEB 2023	Scale NTS @ A1 NTS @ A3	Drawn CG	Checked SMG	Approved SMG
Programme Code BCIDD	Originator Code ROT	QMS Code		

Programme Title BUSCONNECTS DUBLIN CORE BUS CORRIDORS INFRASTRUCTURE WORKS			
Drawing Title KIMMAGE TO CITY CENTRE CORE BUS CORRIDOR SCHEME MAINLINE PLAN & PROFILES COVER SHEET			
Drawing File Name BCIDD-ROT-GEO_IX-0011_ML_00-DR-CR-0001	Sheet Number 01 of 0	Status A	Rev M01

DO NOT SCALE USE FIGURED DIMENSIONS ONLY

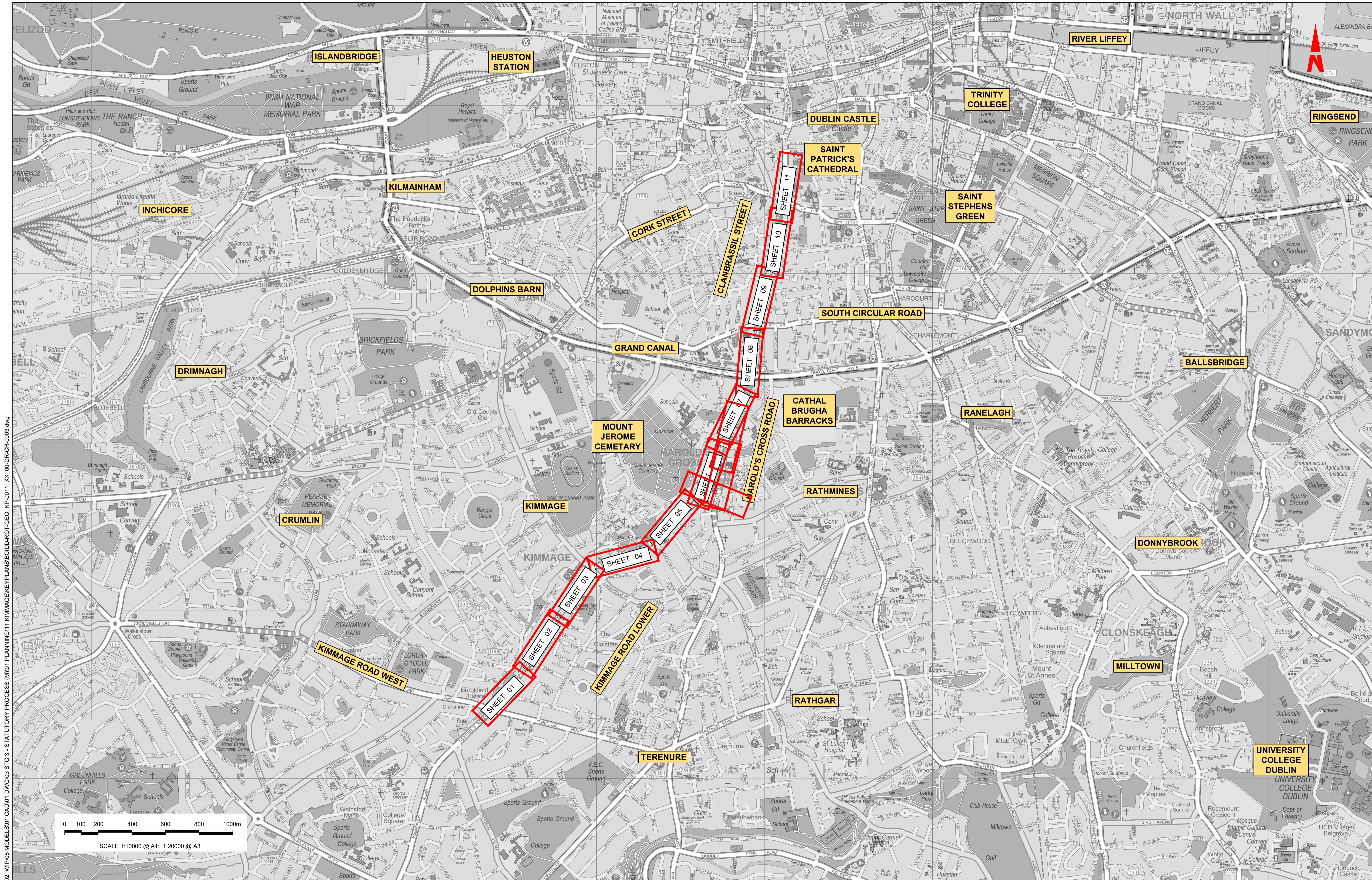

W:\000000\19117117-02_WIP08_MODELS\01_CAD\01_PLANNING\11_KIMMAGE\KEYPLANS\BCIDD-ROT-GEO_KP-0011_XX_00-DR-CR-0003.dwg
 Model: 19117117-02_WIP08_MODELS\01_CAD\01_PLANNING\11_KIMMAGE\KEYPLANS\BCIDD-ROT-GEO_KP-0011_XX_00-DR-CR-0003.dwg

0 100 200 400 600 800 1000m
 SCALE 1:10000 @ A1; 1:20000 @ A3

Disclaimer
 a. © National Transport Authority (NTA) 2022. This drawing is confidential and the copyright in it is owned by NTA. This drawing must not be either loaned, copied or otherwise reproduced in whole or in part or used for any purpose without the prior permission of NTA.
 b. This drawing is to be used for the design element identified in the titleblock. Other information shown is to be considered indicative only. The drawing is to be read in conjunction with all other relevant design drawings.
 c. O.S. data used for plans are printed under © Ordnance Survey Ireland Government of Ireland. All rights reserved. Licence Number 2022/OSI_NMA_180 National Transport Authority. All elevations are in metres and relate to OSI Geoid Model (OSGM15) Mean Head. All Co-ordinates are in Irish Transverse Mercator Grid (ITM) as defined by OSI active local GPS station.
 d. Information concerning the position of apparatus shown on this drawing is based on drawings supplied by the utility owners and/or the utility works contractor, whilst every care has been taken in the preparation of this drawing, positions should be taken as approximate and are intended for general guidance only and no representation is made by the NTA as to the accuracy, completeness, sufficiency or otherwise of this drawing and the position of the apparatus. The information contained herein does not purport to be comprehensive or final as the apparatus is subject to being altered and/or superceded. Recipients should not rely on this information. Any liabilities are hereby expressly disclaimed.

The information contained herein has been provided by the NTA but does not purport to be comprehensive or final. Recipients should not rely on the information. Neither the NTA nor any of its directors, officers, employees, agents, stakeholders or advisers make any representation or warranty as to, or accept any liability or responsibility in relation to, the adequacy, accuracy, reasonableness or completeness of the information provided as part of this document or any matter on which the information is based (including but not limited to loss or damage arising as a result of reliance by recipients on the information or any part of it). Any liabilities are hereby expressly disclaimed.

Rev	Date	Drm	Chk'd	App'd	Description
M01	FEB 2023	CG	SMG	SMG	ISSUE FOR PHASE 4 : PLANNING

Client: **NTA**
 Údarás Náisiúnta Iompair
 National Transport Authority

Engineering Designer: **CIROD**
 TYPSA

Date: FEB 2023
 Scale: 1:10,000 @ A1
 1:20,000 @ A3

Programme Code: BCIDD
 Originator Code: ROT

Drawing: CG
 Checked: SMG
 Approved: SMG

Programme Title			
BUSCONNECTS DUBLIN			
CORE BUS CORRIDORS INFRASTRUCTURE WORKS			
Drawing Title			
KIMMAGE TO CITY CENTRE CORE BUS CORRIDOR SCHEME			
MAINLINE PLAN & PROFILES			
KEYPLAN			
Drawing File Name		Sheet Number	Status
BCIDD-ROT-GEO_KP-0011_XX_00-DR-CR-0003		03 of 01	A
Rev		M01	

DO NOT SCALE USE FIGURED DIMENSIONS ONLY

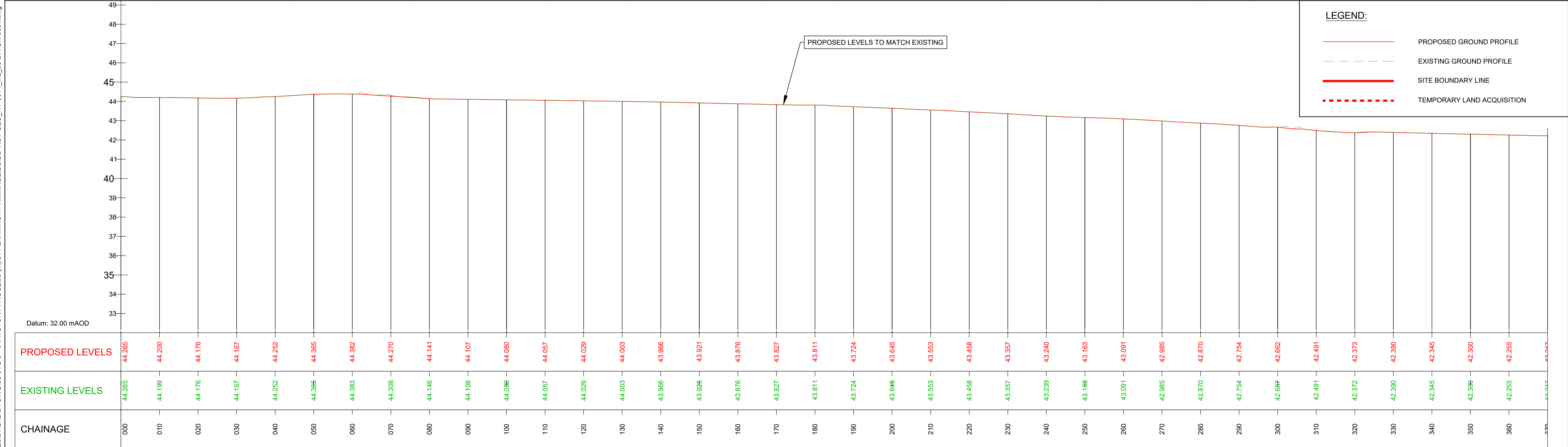
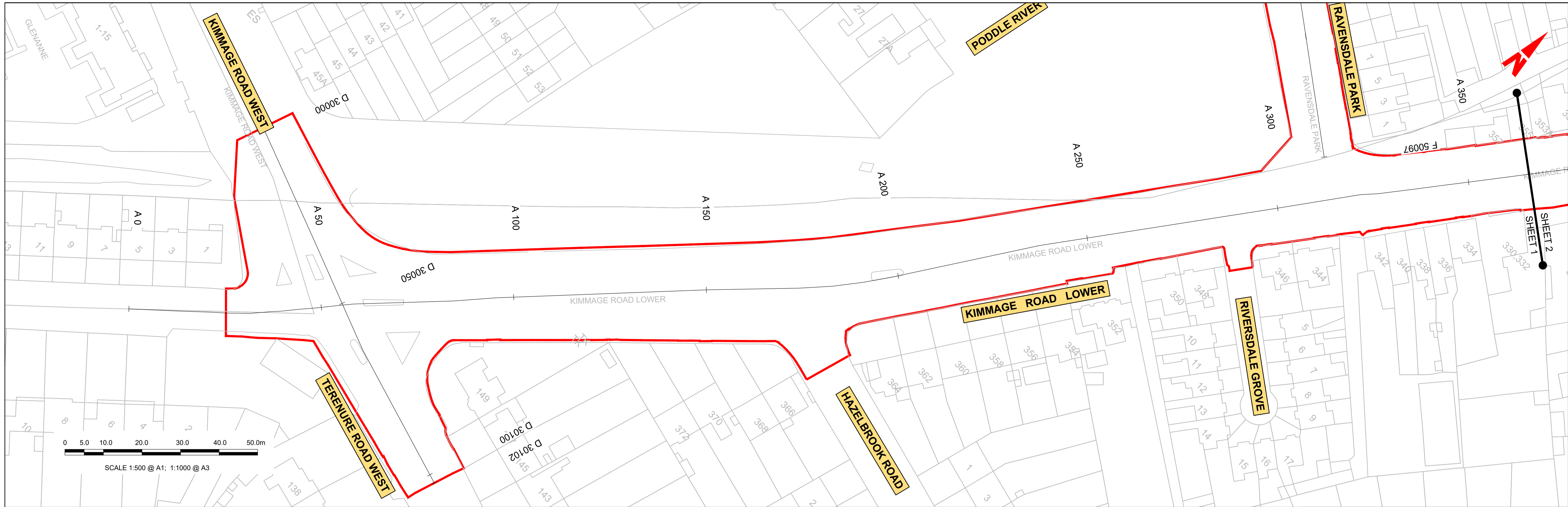

GEO_HV-0011_ML_00-M3-CR-0001-A01
SCALE: H 1:500, V 1:100

<p>Disclaimer</p> <p>a. © National Transport Authority (NTA) 2022. This drawing is confidential and the copyright in it is owned by NTA. This drawing must not be either loaned, copied or otherwise reproduced in whole or in part or used for any purpose without the prior permission of NTA.</p> <p>b. This drawing is to be used for the design element identified in the titleblock. Other information shown is to be considered indicative only. The drawing is to be read in conjunction with all other relevant design drawings.</p> <p>c. O.S. data used for plans are printed under © Ordnance Survey Ireland Government of Ireland. All rights reserved. Licence Number 2022/OSI_NMA_180 National Transport Authority. All elevations are in metres and relate to OSI Geoid Model (OSGM15) Mean Head. All Co-ordinates are in Irish Transverse Mercator Grid (ITM) as defined by OSI active local GPS station.</p> <p>d. Information concerning the position of apparatus shown on this drawing is based on drawings supplied by the utility owners and/or the utility works contractor, whilst every care has been taken in the preparation of this drawing, positions should be taken as approximate and are intended for general guidance only and no representation is made by the NTA as to the accuracy, completeness, sufficiency or otherwise of this drawing and the position of the apparatus. The information contained herein does not purport to be comprehensive or final as the apparatus is subject to being altered and/or superceded. Recipients should not rely on this information. Any liabilities are hereby expressly disclaimed.</p> <p>e. The information contained herein has been provided by the NTA but does not purport to be comprehensive or final. Recipients should not rely on the information. Neither the NTA nor any of its directors, officers, employees, agents, stakeholders or advisers make any representation or warranty as to, or accept any liability or responsibility in relation to, the adequacy, accuracy, reasonableness or completeness of the information provided as part of this document or any matter on which the information is based (including but not limited to loss or damage arising as a result of reliance by recipients on the information or any part of it). Any liabilities are hereby expressly disclaimed.</p>		<table border="1"> <tr> <th>Rev</th> <th>Date</th> <th>Dwn</th> <th>Chk'd</th> <th>App'd</th> <th>Description</th> </tr> <tr> <td>M01</td> <td>FEB 2023</td> <td>CG</td> <td>SMG</td> <td>SMG</td> <td>ISSUED FOR PHASE 4: PLANNING</td> </tr> </table>	Rev	Date	Dwn	Chk'd	App'd	Description	M01	FEB 2023	CG	SMG	SMG	ISSUED FOR PHASE 4: PLANNING	<p>Client</p> <p>Údarás Náisiúnta Iompair National Transport Authority</p>	<p>Engineering Designer</p> <p>TYPSA</p>	<p>Programme Title</p> <p>BUSCONNECTS DUBLIN CORE BUS CORRIDORS INFRASTRUCTURE WORKS</p>
		Rev	Date	Dwn	Chk'd	App'd	Description										
M01	FEB 2023	CG	SMG	SMG	ISSUED FOR PHASE 4: PLANNING												
<p>Date</p> <p>FEB 2023</p> <p>Programme Code</p> <p>BCIDD</p>	<p>Scale</p> <p>1:500 @ A1 1:1,000 @ A3</p> <p>Originator Code</p> <p>ROT</p>	<p>Drawn</p> <p>CG</p> <p>Checked</p> <p>SMG</p> <p>Approved</p> <p>SMG</p>	<p>QMS Code</p>	<p>Drawing File Name</p> <p>BCIDD-ROT-GEO_HV-0011_ML_00-DR-CR-0001</p>	<p>Sheet Number</p> <p>01 of 11</p>	<p>Status</p> <p>A</p>	<p>Rev</p> <p>M01</p>										

DO NOT SCALE USE FIGURED DIMENSIONS ONLY

\\produbp1u2019191719117-02_WIP08 MODELS01 CAD01 DWG03 STG 3 - STATUTORY PROCESS (M)01 PLANNING11 KIMMAGE\BCIDD-ROT-GEO_HV-0011_ML_00-DR-CR-0001.dwg

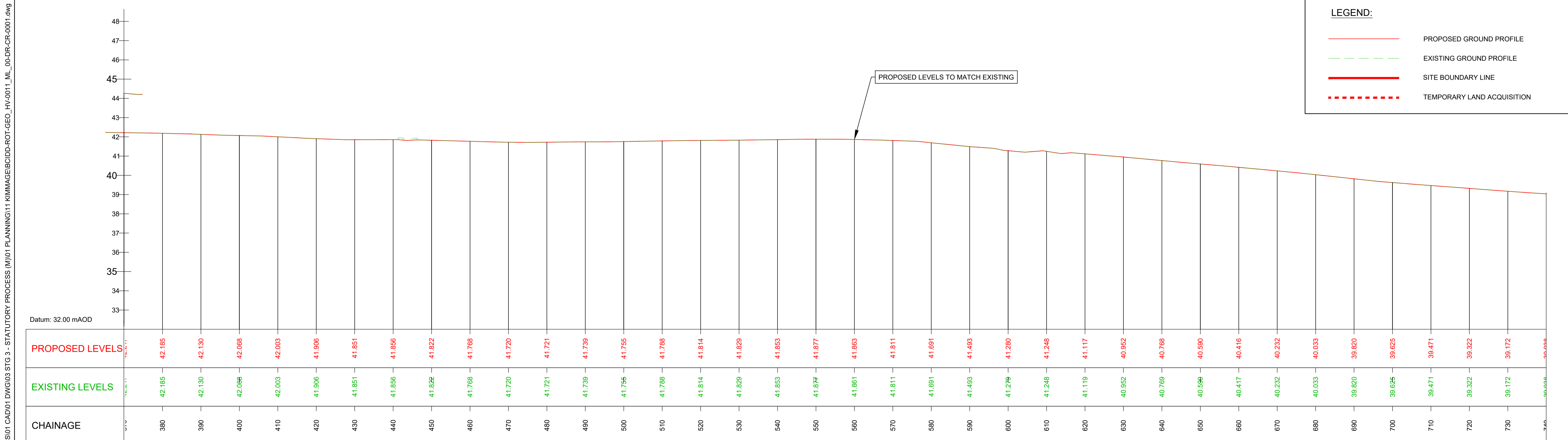
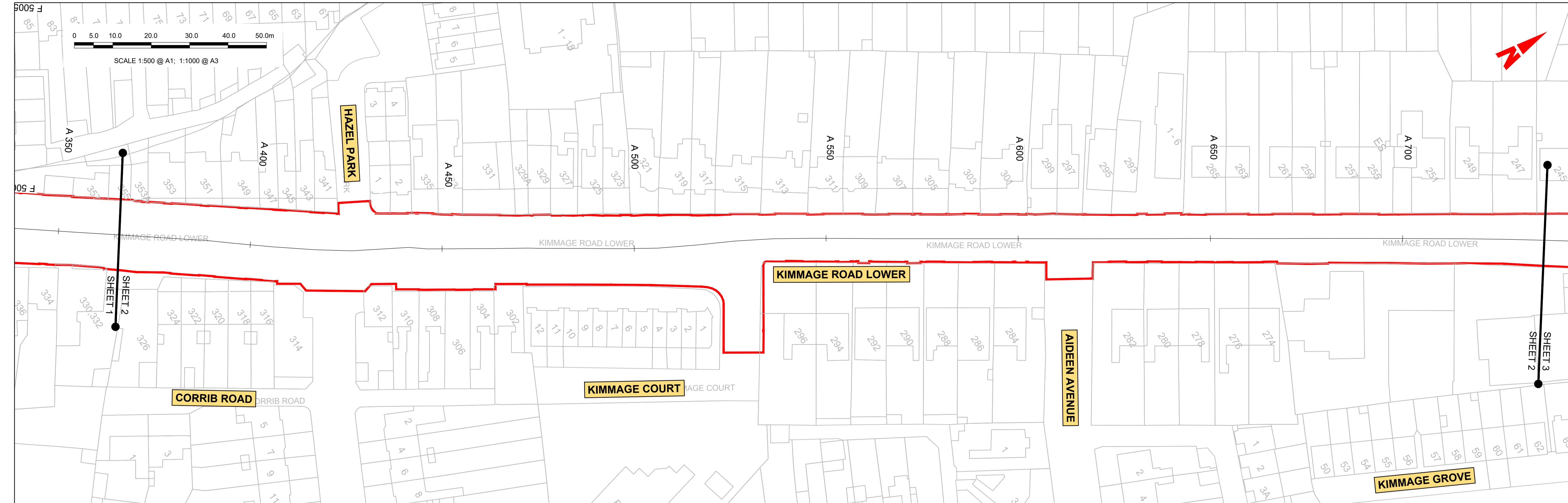

GEO_HV-0011_ML_00-M3-CR-0001-A01
SCALE: H 1:500, V 1:100

<p>Disclaimer</p> <p>a. © National Transport Authority (NTA) 2022. This drawing is confidential and the copyright in it is owned by NTA. This drawing must not be either loaned, copied or otherwise reproduced in whole or in part or used for any purpose without the prior permission of NTA.</p> <p>b. This drawing is to be used for the design element identified in the titlebox. Other information shown is to be considered indicative only. The drawing is to be read in conjunction with all other relevant design drawings.</p> <p>c. O.S. data used for plans are printed under © Ordnance Survey Ireland Government of Ireland. All rights reserved. Licence Number 2022/OSI_NMA_180 National Transport Authority. All elevations are in metres and relate to OSI Geoid Model (OSGM15) Mean Head. All Co-ordinates are in Irish Transverse Mercator Grid (ITM) as defined by OSI active local GPS station.</p> <p>d. Information concerning the position of apparatus shown on this drawing is based on drawings supplied by the utility owners and/or the utility works contractor, whilst every care has been taken in the preparation of this drawing, positions should be taken as approximate and are intended for general guidance only and no representation is made by the NTA as to the accuracy, completeness, sufficiency or otherwise of this drawing and the position of the apparatus. The information contained herein does not purport to be comprehensive or final as the apparatus is subject to being altered and/or superceded. Recipients should not rely on this information. Any liabilities are hereby expressly disclaimed.</p> <p>e. The information contained herein has been provided by the NTA but does not purport to be comprehensive or final. Recipients should not rely on the information. Neither the NTA nor any of its directors, officers, employees, agents, stakeholders or advisers make any representation or warranty as to, or accept any liability or responsibility in relation to, the adequacy, accuracy, reasonableness or completeness of the information provided as part of this document or any matter on which the information is based (including but not limited to loss or damage arising as a result of reliance by recipients on the information or any part of it). Any liabilities are hereby expressly disclaimed.</p>		<table border="1"> <thead> <tr> <th>Rev</th> <th>Date</th> <th>Drn</th> <th>Chk'd</th> <th>App'd</th> <th>Description</th> </tr> </thead> <tbody> <tr> <td>M01</td> <td>FEB 2023</td> <td>CG</td> <td>SMG</td> <td>SMG</td> <td>ISSUED FOR PHASE 4: PLANNING</td> </tr> </tbody> </table>	Rev	Date	Drn	Chk'd	App'd	Description	M01	FEB 2023	CG	SMG	SMG	ISSUED FOR PHASE 4: PLANNING	<table border="1"> <tr> <td colspan="2">Client</td> <td colspan="2">Engineering Designer</td> </tr> <tr> <td colspan="2"> Údarás Náisiúnta Iompair National Transport Authority </td> <td colspan="2"> CIROD TYPSA </td> </tr> <tr> <td>Date</td> <td>Scale</td> <td>Drawn</td> <td>Checked</td> </tr> <tr> <td>FEB 2023</td> <td>1:500 @ A1 1:1,000 @ A3</td> <td>CG</td> <td>SMG</td> </tr> <tr> <td>Programme Code</td> <td>Originator Code</td> <td>QMS Code</td> <td>Approved</td> </tr> <tr> <td>BCIDD</td> <td>ROT</td> <td></td> <td>SMG</td> </tr> </table>	Client		Engineering Designer		 Údarás Náisiúnta Iompair National Transport Authority		 CIROD TYPSA		Date	Scale	Drawn	Checked	FEB 2023	1:500 @ A1 1:1,000 @ A3	CG	SMG	Programme Code	Originator Code	QMS Code	Approved	BCIDD	ROT		SMG	<table border="1"> <tr> <td colspan="4">Programme Title</td> </tr> <tr> <td colspan="4">BUSCONNECTS DUBLIN CORE BUS CORRIDORS INFRASTRUCTURE WORKS</td> </tr> <tr> <td colspan="4">Drawing Title</td> </tr> <tr> <td colspan="4">KIMMAGE TO CITY CENTRE CORE BUS CORRIDOR SCHEME MAINLINE PLAN & PROFILES</td> </tr> <tr> <td>Drawing File Name</td> <td>Sheet Number</td> <td>Status</td> <td>Rev</td> </tr> <tr> <td>BCIDD-ROT-GEO_HV-0011_ML_00-DR-CR-0002</td> <td>02 of 11</td> <td>A</td> <td>M01</td> </tr> </table>	Programme Title				BUSCONNECTS DUBLIN CORE BUS CORRIDORS INFRASTRUCTURE WORKS				Drawing Title				KIMMAGE TO CITY CENTRE CORE BUS CORRIDOR SCHEME MAINLINE PLAN & PROFILES				Drawing File Name	Sheet Number	Status	Rev	BCIDD-ROT-GEO_HV-0011_ML_00-DR-CR-0002	02 of 11	A	M01
		Rev	Date	Drn	Chk'd	App'd	Description																																																									
M01	FEB 2023	CG	SMG	SMG	ISSUED FOR PHASE 4: PLANNING																																																											
Client		Engineering Designer																																																														
 Údarás Náisiúnta Iompair National Transport Authority		 CIROD TYPSA																																																														
Date	Scale	Drawn	Checked																																																													
FEB 2023	1:500 @ A1 1:1,000 @ A3	CG	SMG																																																													
Programme Code	Originator Code	QMS Code	Approved																																																													
BCIDD	ROT		SMG																																																													
Programme Title																																																																
BUSCONNECTS DUBLIN CORE BUS CORRIDORS INFRASTRUCTURE WORKS																																																																
Drawing Title																																																																
KIMMAGE TO CITY CENTRE CORE BUS CORRIDOR SCHEME MAINLINE PLAN & PROFILES																																																																
Drawing File Name	Sheet Number	Status	Rev																																																													
BCIDD-ROT-GEO_HV-0011_ML_00-DR-CR-0002	02 of 11	A	M01																																																													
<p>DO NOT SCALE USE FIGURED DIMENSIONS ONLY</p>																																																																

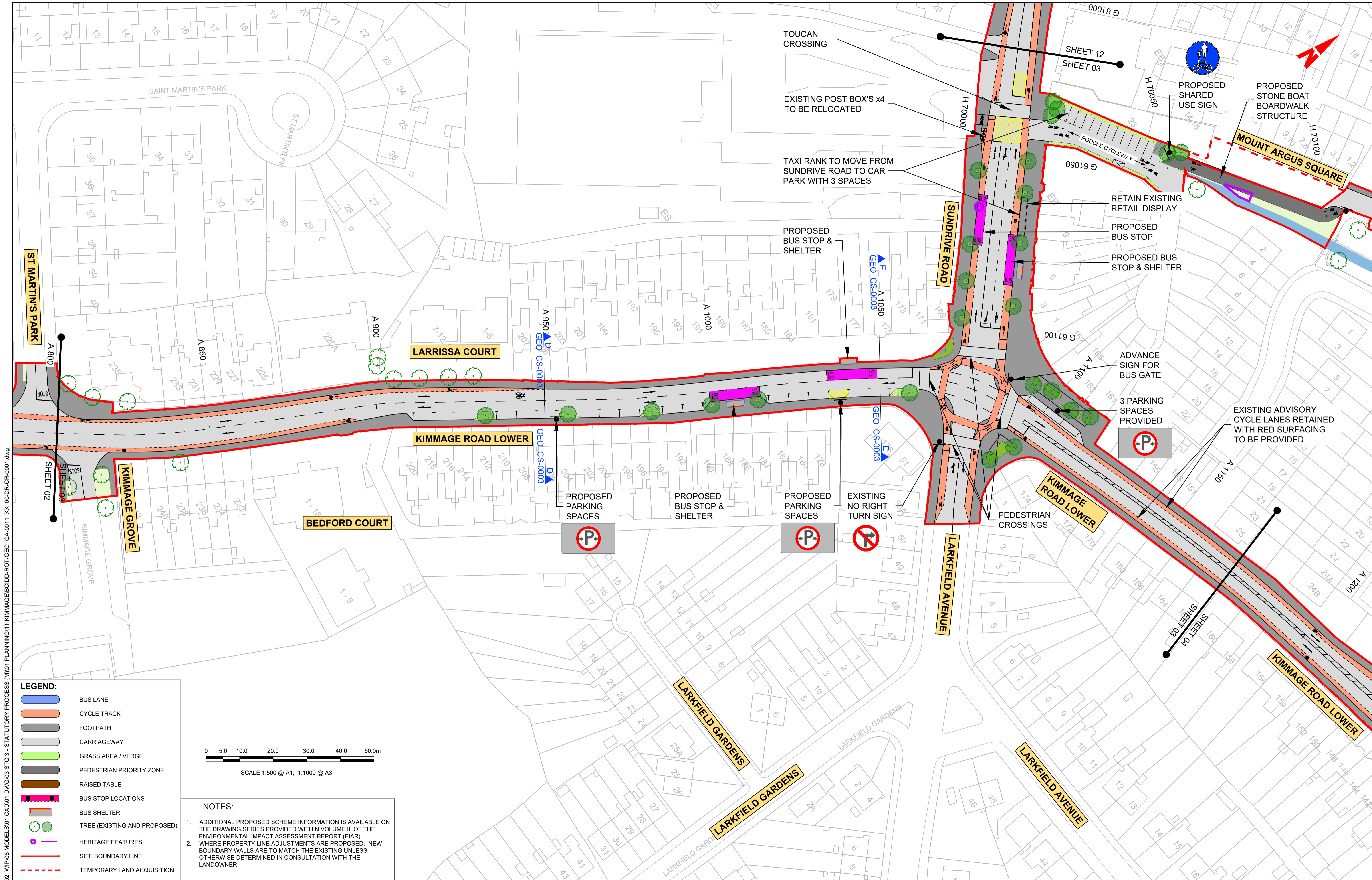

W:\000000\11\171117-02_WIP\08 MODELS\01 CAD\01 DWG\03 STG 3 - STATUTORY PROCESS (M)\01 PLANNING\11 KIMMAGE\BCIDD-ROT-GEO_GA-0011_XX_00-DR-CR-0001.dwg
 SHEET 02
 SHEET 03
 SHEET 04

LEGEND:

- BUS LANE
- CYCLE TRACK
- FOOTPATH
- CARRIAGEWAY
- GRASS AREA / VERGE
- PEDESTRIAN PRIORITY ZONE
- RAISED TABLE
- BUS STOP LOCATIONS
- BUS SHELTER
- TREE (EXISTING AND PROPOSED)
- HERITAGE FEATURES
- SITE BOUNDARY LINE
- TEMPORARY LAND ACQUISITION

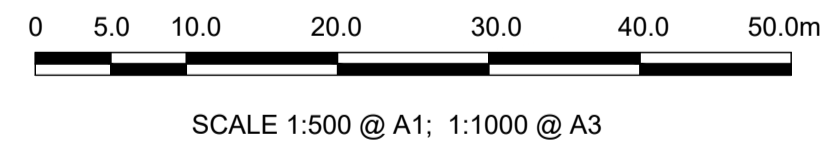

NOTES:

- ADDITIONAL PROPOSED SCHEME INFORMATION IS AVAILABLE ON THE DRAWING SERIES PROVIDED WITHIN VOLUME III OF THE ENVIRONMENTAL IMPACT ASSESSMENT REPORT (EIAR).
- WHERE PROPERTY LINE ADJUSTMENTS ARE PROPOSED, NEW BOUNDARY WALLS ARE TO MATCH THE EXISTING UNLESS OTHERWISE DETERMINED IN CONSULTATION WITH THE LANDOWNER.

Disclaimer:
 a. © National Transport Authority (NTA) 2022. This drawing is confidential and the copyright in it is owned by NTA. This drawing must not be either loaned, copied or otherwise reproduced in whole or in part or used for any purpose without the prior permission of NTA.
 b. This drawing is to be used for the design element identified in the titleblock. Other information shown is to be considered indicative only. The drawing is to be read in conjunction with all other relevant design drawings.
 c. O.S. data used for plans are printed under © Ordnance Survey Ireland Government of Ireland. All rights reserved. Licence Number 2022/OSI_NMA_180 National Transport Authority. All elevations are in metres and relate to OSI Geoid Model (OSGM15) Mean Head. All Co-ordinates are in Irish Transverse Mercator Grid (ITM) as defined by OSI active local GPS station.
 d. Information concerning the position of apparatus shown on this drawing is based on drawings supplied by the utility owners and/or the utility works contractor, whilst every care has been taken in the preparation of this drawing, positions should be taken as approximate and are intended for general guidance only and no representation is made by the NTA as to the accuracy, completeness, sufficiency or otherwise of this drawing and the position of the apparatus. The information contained herein does not purport to be comprehensive or final as the apparatus is subject to being altered and/or superceded. Recipients should not rely on this information. Any liabilities are hereby expressly disclaimed.

The information contained herein has been provided by the NTA but does not purport to be comprehensive or final. Recipients should not rely on the information. Neither the NTA nor any of its directors, officers, employees, agents, stakeholders or advisers make any representation or warranty as to, or accept any liability or responsibility in relation to, the adequacy, accuracy, reasonableness or completeness of the information provided as part of this document or any matter on which the information is based (including but not limited to loss or damage arising as a result of reliance by recipients on the information or any part of it). Any liabilities are hereby expressly disclaimed.



Rev	Date	Drn	Chk'd	App'd	Description
M01	FEB 2023	DA	SMG	SMG	ISSUED FOR PHASE 4: PLANNING

Client: **NTA**
 Údarás Náisiúnta Iompair
 National Transport Authority

Engineering Designer: **CIROD**
 TYPSA

Date: FEB 2023
 Scale: 1:500 @ A1, 1:1,000 @ A3
 Programme Code: BCIDD
 Originator Code: ROT

Drawn: DA
 Checked: SMG
 Approved: SMG

Programme Title: BUSCONNECTS DUBLIN CORE BUS CORRIDORS INFRASTRUCTURE WORKS			
Drawing Title: KIMMAGE TO CITY CENTRE CORE BUS CORRIDOR SCHEME GENERAL ARRANGEMENT			
Drawing File Name: BCIDD-ROT-GEO_GA-0011_XX_00-DR-CR-0003	Sheet Number: 03 of 14	Status: A	Rev: M01

DO NOT SCALE USE FIGURED DIMENSIONS ONLY

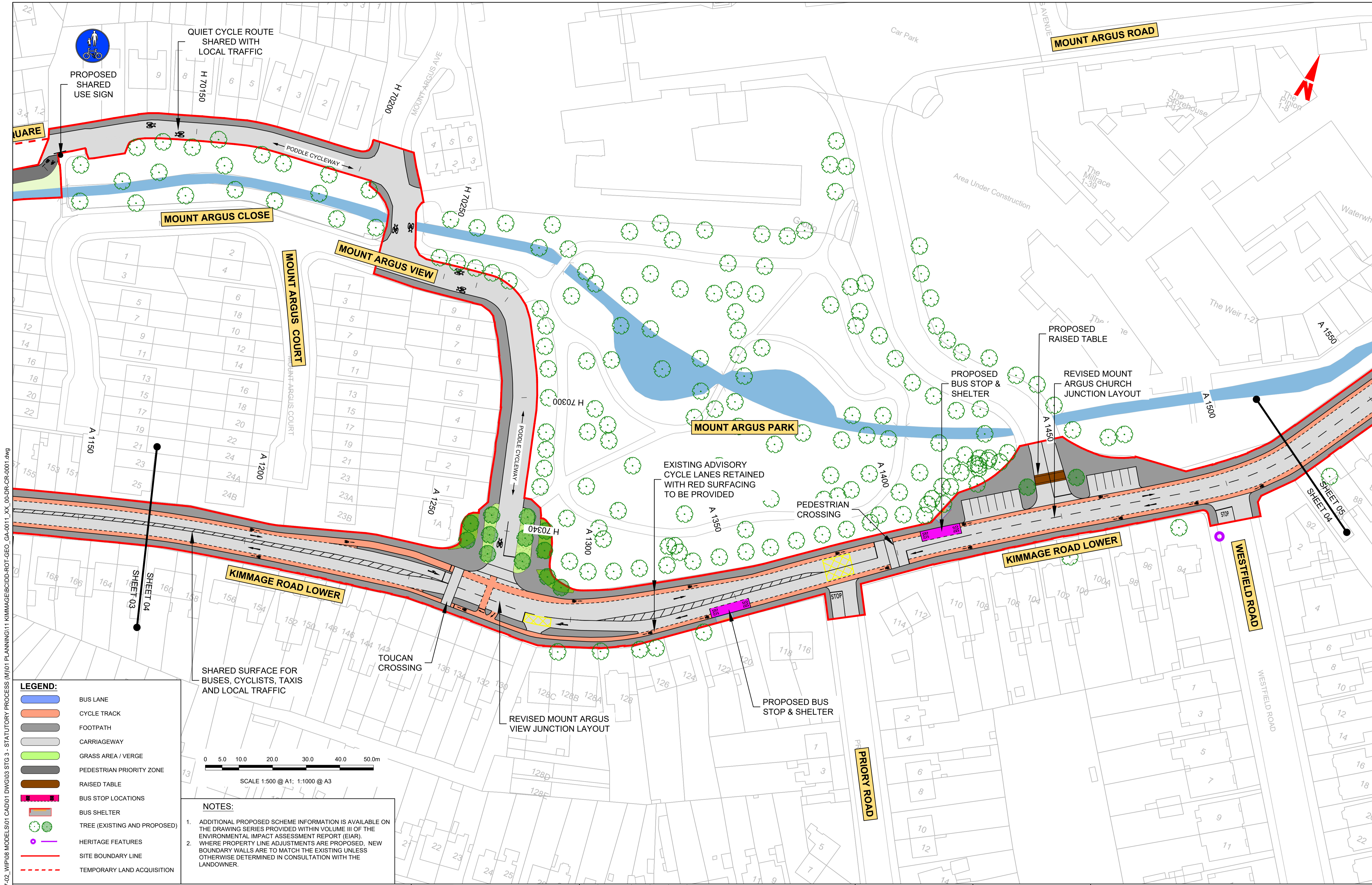

PROPOSED SHARED USE SIGN

QUIET CYCLE ROUTE SHARED WITH LOCAL TRAFFIC

MOUNT ARGUS CLOSE

MOUNT ARGUS COURT

MOUNT ARGUS VIEW

MOUNT ARGUS PARK

MOUNT ARGUS ROAD

PROPOSED RAISED TABLE

PROPOSED BUS STOP & SHELTER

REVISED MOUNT ARGUS CHURCH JUNCTION LAYOUT

EXISTING ADVISORY CYCLE LANES RETAINED WITH RED SURFACING TO BE PROVIDED

PEDESTRIAN CROSSING

KIMMAGE ROAD LOWER

WESTFIELD ROAD

KIMMAGE ROAD LOWER

SHARED SURFACE FOR BUSES, CYCLISTS, TAXIS AND LOCAL TRAFFIC

TOUCAN CROSSING

REVISED MOUNT ARGUS VIEW JUNCTION LAYOUT

PROPOSED BUS STOP & SHELTER

PRIORITY ROAD

- LEGEND:**
- BUS LANE
 - CYCLE TRACK
 - FOOTPATH
 - CARRIAGEWAY
 - GRASS AREA / VERGE
 - PEDESTRIAN PRIORITY ZONE
 - RAISED TABLE
 - BUS STOP LOCATIONS
 - BUS SHELTER
 - TREE (EXISTING AND PROPOSED)
 - HERITAGE FEATURES
 - SITE BOUNDARY LINE
 - TEMPORARY LAND ACQUISITION

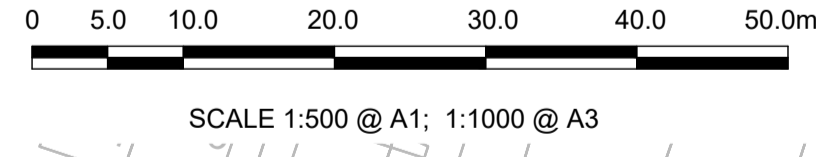

- NOTES:**
- ADDITIONAL PROPOSED SCHEME INFORMATION IS AVAILABLE ON THE DRAWING SERIES PROVIDED WITHIN VOLUME III OF THE ENVIRONMENTAL IMPACT ASSESSMENT REPORT (EIAR).
 - WHERE PROPERTY LINE ADJUSTMENTS ARE PROPOSED, NEW BOUNDARY WALLS ARE TO MATCH THE EXISTING UNLESS OTHERWISE DETERMINED IN CONSULTATION WITH THE LANDOWNER.

Disclaimer
 a. © National Transport Authority (NTA) 2022. This drawing is confidential and the copyright in it is owned by NTA. This drawing must not be either loaned, copied or otherwise reproduced in whole or in part or used for any purpose without the prior permission of NTA.
 b. This drawing is to be used for the design element identified in the titleblock. Other information shown is to be considered indicative only. The drawing is to be read in conjunction with all other relevant design drawings.
 c. O.S. data used for plans are printed under © Ordnance Survey Ireland Government of Ireland. All rights reserved. Licence Number 2022/OSI_NMA_180 National Transport Authority. All elevations are in metres and relate to OSI Geoid Model (OSGM15) Mean Head. All Co-ordinates are in Irish Transverse Mercator Grid (ITM) as defined by OSI active local GPS station.
 d. Information concerning the position of apparatus shown on this drawing is based on drawings supplied by the utility owners, and/or the utility works contractor, whilst every care has been taken in the preparation of this drawing, positions should be taken as approximate and are intended for general guidance only and no representation is made by the NTA as to the accuracy, completeness, sufficiency or otherwise of this drawing and the position of the apparatus. The information contained herein does not purport to be comprehensive or final as the apparatus is subject to being altered and/or superseded. Recipients should not rely on this information. Any liabilities are hereby expressly disclaimed.

The information contained herein has been provided by the NTA but does not purport to be comprehensive or final. Recipients should not rely on the information. Neither the NTA nor any of its directors, officers, employees, agents, stakeholders or advisers make any representation or warranty as to, or accept any liability or responsibility in relation to, the adequacy, accuracy, reasonableness or completeness of the information provided as part of this document or any matter on which the information is based (including but not limited to loss or damage arising as a result of reliance by recipients on the information or any part of it). Any liabilities are hereby expressly disclaimed.

Project Ireland 2040
 Building Ireland's Future

Rev	Date	Drn	Chk'd	App'd	Description
M01	FEB 2023	DA	SMG	SMG	ISSUED FOR PHASE 4: PLANNING

Client		Engineering Designer	
 Údarás Náisiúnta Iompair National Transport Authority		 FROD TYPSA	
Date	Scale	Drawn	Checked
FEB 2023	1:500 @ A1 1:1,000 @ A3	DA	SMG
Programme Code	Originator Code	QMS Code	Approved
BCIDD	ROT		SMG

Programme Title		Drawing Title	
BUSCONNECTS DUBLIN CORE BUS CORRIDORS INFRASTRUCTURE WORKS		KIMMAGE TO CITY CENTRE CORE BUS CORRIDOR SCHEME GENERAL ARRANGEMENT	
Drawing File Name	Sheet Number	Status	Rev
BCIDD-ROT-GEO_GA-0011_XX_00-DR-CR-0004	04 of 14	A	M01

DO NOT SCALE USE FIGURED DIMENSIONS ONLY

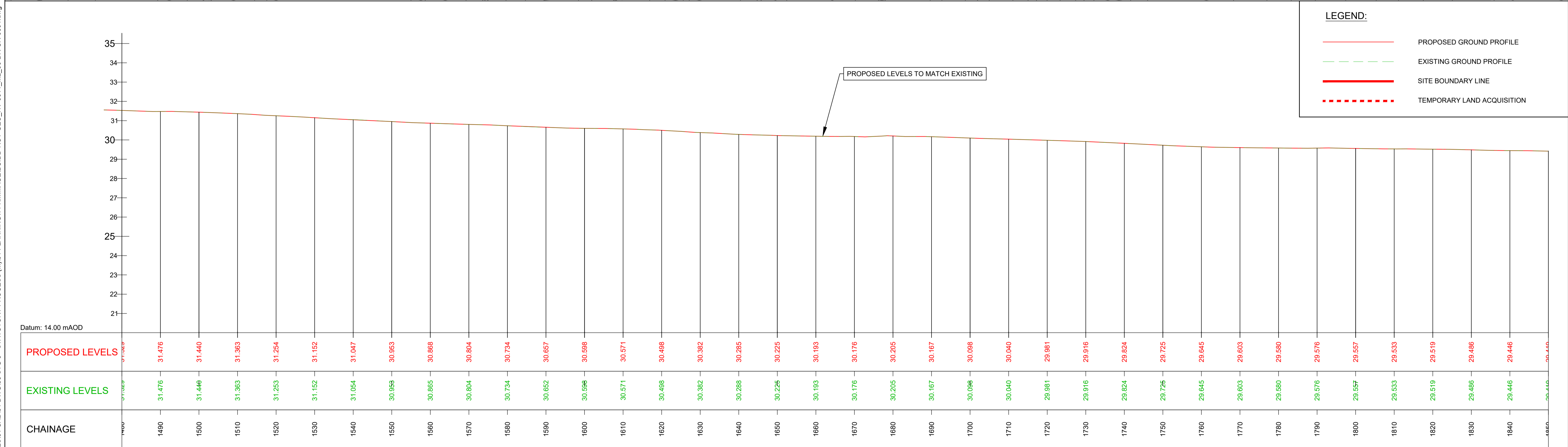
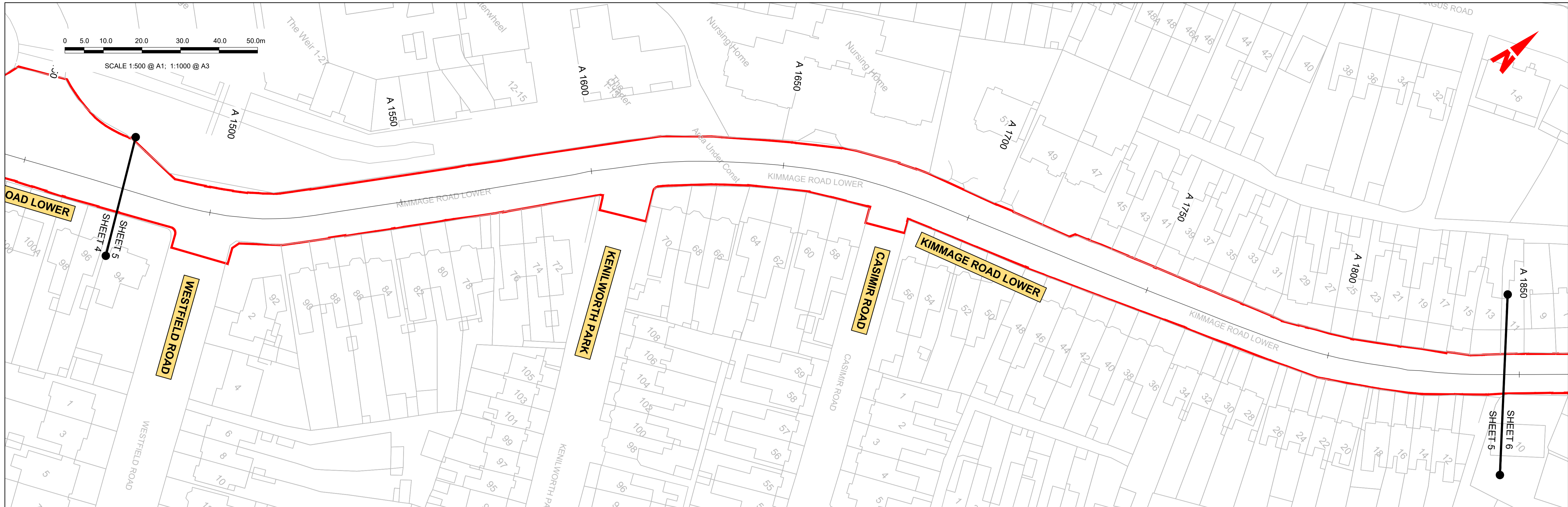

GEO_HV-0011_ML_00-M3-CR-0001-A01
SCALE: H 1:500, V 1:100

<p>Disclaimer</p> <p>a. © National Transport Authority (NTA) 2022. This drawing is confidential and the copyright in it is owned by NTA. This drawing must not be either loaned, copied or otherwise reproduced in whole or in part or used for any purpose without the prior permission of NTA.</p> <p>b. This drawing is to be used for the design element identified in the titlebox. Other information shown is to be considered indicative only. The drawing is to be read in conjunction with all other relevant design drawings.</p> <p>c. O.S. data used for plans are printed under © Ordnance Survey Ireland Government of Ireland. All rights reserved. Licence Number 2022/OSI_NMA_180 National Transport Authority. All elevations are in metres and relate to OSI Geoid Model (OSGM15) Mean Head. All Co-ordinates are in Irish Transverse Mercator Grid (ITM) as defined by OSI active local GPS station.</p> <p>d. Information concerning the position of apparatus shown on this drawing is based on drawings supplied by the utility owners and/or the utility works contractor, whilst every care has been taken in the preparation of this drawing, positions should be taken as approximate and are intended for general guidance only and no representation is made by the NTA as to the accuracy, completeness, sufficiency or otherwise of this drawing and the position of the apparatus. The information contained herein does not purport to be comprehensive or final as the apparatus is subject to being altered and/or superceded. Recipients should not rely on this information. Any liabilities are hereby expressly disclaimed.</p> <p>e. The information contained herein has been provided by the NTA but does not purport to be comprehensive or final. Recipients should not rely on the information. Neither the NTA nor any of its directors, officers, employees, agents, stakeholders or advisers make any representation or warranty as to, or accept any liability or responsibility in relation to, the adequacy, accuracy, reasonableness or completeness of the information provided as part of this document or any matter on which the information is based (including but not limited to loss or damage arising as a result of reliance by recipients on the information or any part of it). Any liabilities are hereby expressly disclaimed.</p>		<table border="1"> <thead> <tr> <th>Rev</th> <th>Date</th> <th>Drn</th> <th>Chk'd</th> <th>App'd</th> <th>Description</th> </tr> </thead> <tbody> <tr> <td>M01</td> <td>FEB 2023</td> <td>CG</td> <td>SMG</td> <td>SMG</td> <td>ISSUED FOR PHASE 4: PLANNING</td> </tr> </tbody> </table>	Rev	Date	Drn	Chk'd	App'd	Description	M01	FEB 2023	CG	SMG	SMG	ISSUED FOR PHASE 4: PLANNING	<p>Client</p> <p>Údarás Náisiúnta Iompair National Transport Authority</p>	<p>Engineering Designer</p> <p>TYPSA</p>	<p>Programme Title</p> <p>BUSCONNECTS DUBLIN CORE BUS CORRIDORS INFRASTRUCTURE WORKS</p>
		Rev	Date	Drn	Chk'd	App'd	Description										
M01	FEB 2023	CG	SMG	SMG	ISSUED FOR PHASE 4: PLANNING												
<p>Date</p> <p>FEB 2023</p> <p>Scale</p> <p>1:500 @ A1 1:1,000 @ A3</p> <p>Programme Code</p> <p>BCIDD</p> <p>Originator Code</p> <p>ROT</p> <p>QMS Code</p> <p>QMS Code</p>	<p>Drawn</p> <p>CG</p> <p>Checked</p> <p>SMG</p> <p>Approved</p> <p>SMG</p>	<p>Drawing Title</p> <p>KIMMAGE TO CITY CENTRE CORE BUS CORRIDOR SCHEME MAINLINE PLAN & PROFILES</p>	<p>Drawing File Name</p> <p>BCIDD-ROT-GEO_HV-0011_ML_00-DR-CR-0005</p> <p>Sheet Number</p> <p>05 of 11</p> <p>Status</p> <p>A</p> <p>Rev</p> <p>M01</p>														

DO NOT SCALE USE FIGURED DIMENSIONS ONLY

\\nodubp1u201919171717-02_WIP008 MODELS01 CAD01 DWG003 STG 3 - STATUTORY PROCESS (M)01 PLANNING11 KIMMAGEBCIDD-ROT-GEO_HV-0011_ML_00-DR-CR-0001.dwg

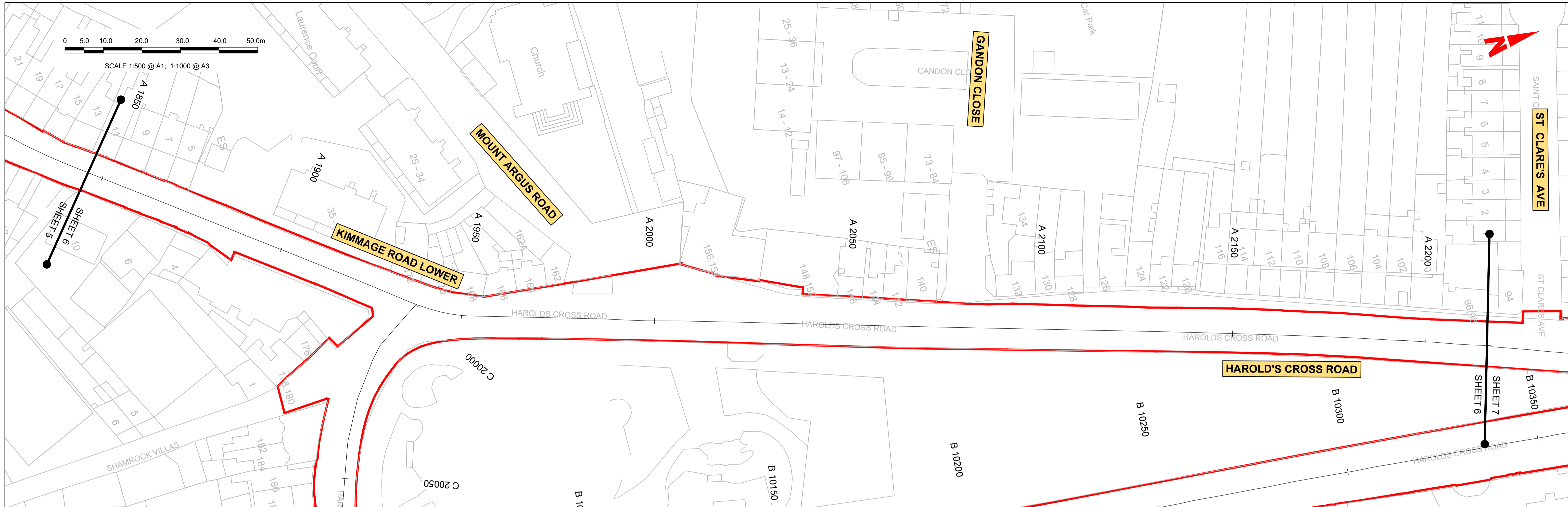

LEGEND:

- PROPOSED GROUND PROFILE
- - - EXISTING GROUND PROFILE
- - - - - SITE BOUNDARY LINE
- - - - - TEMPORARY LAND ACQUISITION

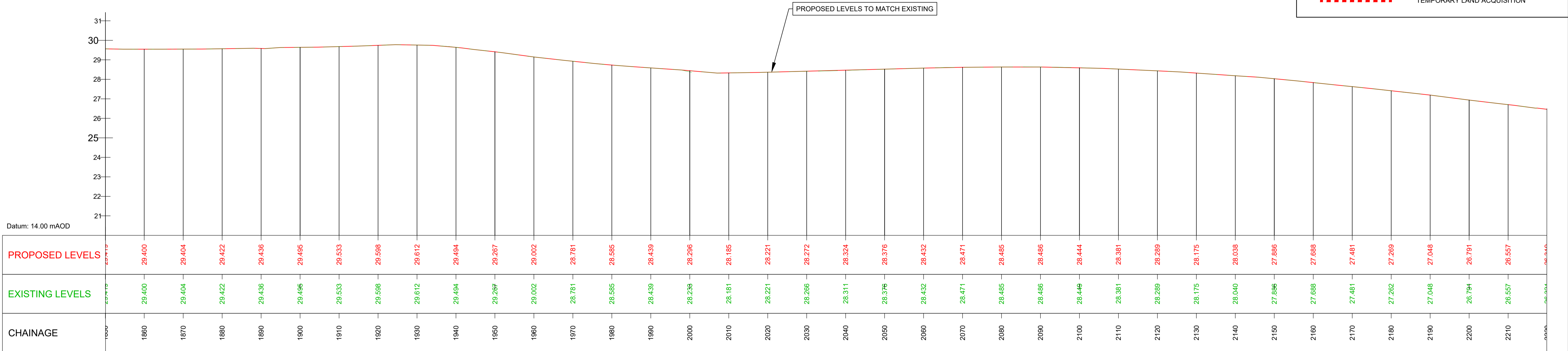

GEO_HV-0011_ML_00-M3-CR-0001-A01
SCALE: H 1:500, V 1:100

Disclaimer:

a. © National Transport Authority (NTA) 2022. This drawing is confidential and the copyright in it is owned by NTA. This drawing must not be either loaned, copied or otherwise reproduced in whole or in part or used for any purpose without the prior permission of NTA.

b. This drawing is to be used for the design element identified in the titleblock. Other information shown is to be considered indicative only. The drawing is to be read in conjunction with all other relevant design drawings.

c. O.S. data used for plans are printed under © Ordnance Survey Ireland Government of Ireland. All rights reserved. Licence Number 2022/OSI_NMA_180 National Transport Authority. All elevations are in metres and relate to OSI Geoid Model (OSGM15) Mean Head. All Co-ordinates are in Irish Transverse Mercator Grid (ITM) as defined by OSI active local GPS station.

d. Information concerning the position of apparatus shown on this drawing is based on drawings supplied by the utility owners and/or the utility works contractor, whilst every care has been taken in the preparation of this drawing, positions should be taken as approximate and are intended for general guidance only and no representation is made by the NTA as to the accuracy, completeness, sufficiency or otherwise of this drawing and the position of the apparatus. The information contained herein does not purport to be comprehensive or final as the apparatus is subject to being altered and/or superseded. Recipients should not rely on this information. Any liabilities are hereby expressly disclaimed.

e. The information contained herein has been provided by the NTA but does not purport to be comprehensive or final. Recipients should not rely on the information. Neither the NTA nor any of its directors, officers, employees, agents, stakeholders or advisers make any representation or warranty as to, or accept any liability or responsibility in relation to, the adequacy, accuracy, reasonableness or completeness of the information provided as part of this document or any matter on which the information is based (including but not limited to loss or damage arising as a result of reliance by recipients on the information or any part of it). Any liabilities are hereby expressly disclaimed.

Rev	Date	Drn	Chk'd	App'd	Description
M01	FEB 2023	CG	SMG	SMG	ISSUED FOR PHASE 4: PLANNING

Date: FEB 2023	Scale: 1:500 @ A1, 1:1,000 @ A3	Drawn: CG	Checked: SMG	Approved: SMG
Programme Code: BCIDD	Originator Code: ROT	QMS Code:		

Programme Title BUSCONNECTS DUBLIN CORE BUS CORRIDORS INFRASTRUCTURE WORKS			
Drawing Title KIMMAGE TO CITY CENTRE CORE BUS CORRIDOR SCHEME MAINLINE PLAN & PROFILES			
Drawing File Name: BCIDD-ROT-GEO_HV-0011_ML_00-DR-CR-0006	Sheet Number: 06 of 11	Status: A	Rev: M01

DO NOT SCALE USE FIGURED DIMENSIONS ONLY

\\nodubp1\U201919\171717-02_WIP\08 MODELS\01 CAD\01 DWG\03 STG 3 - STATUTORY PROCESS (M)\01 PLANNING\11 KIMMAGE\BCIDD-ROT-GEO_HV-0011_ML_00-DR-CR-0001.dwg

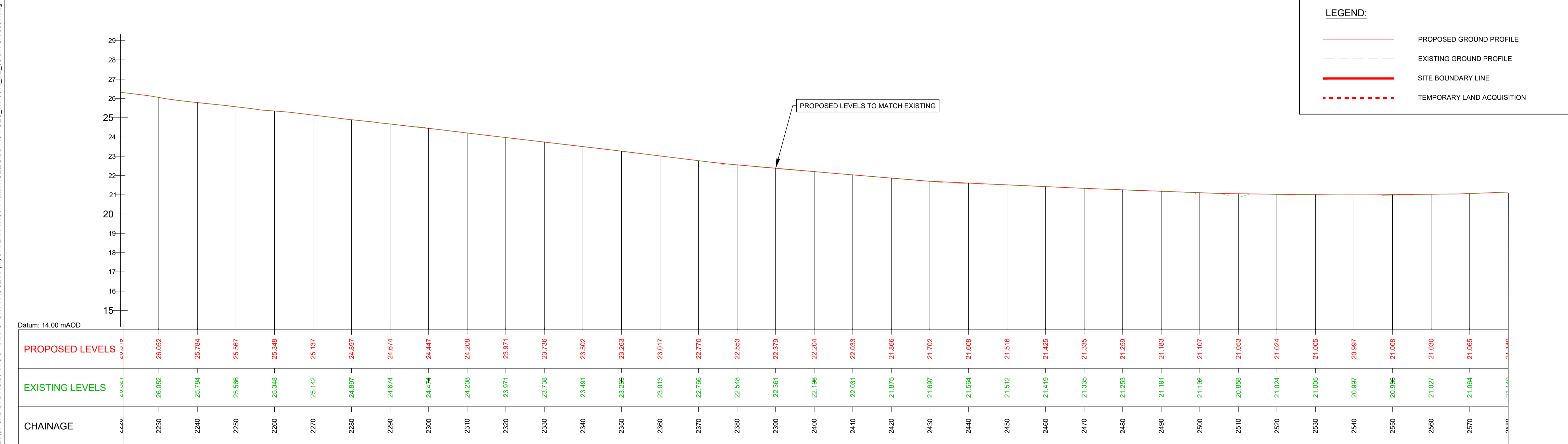
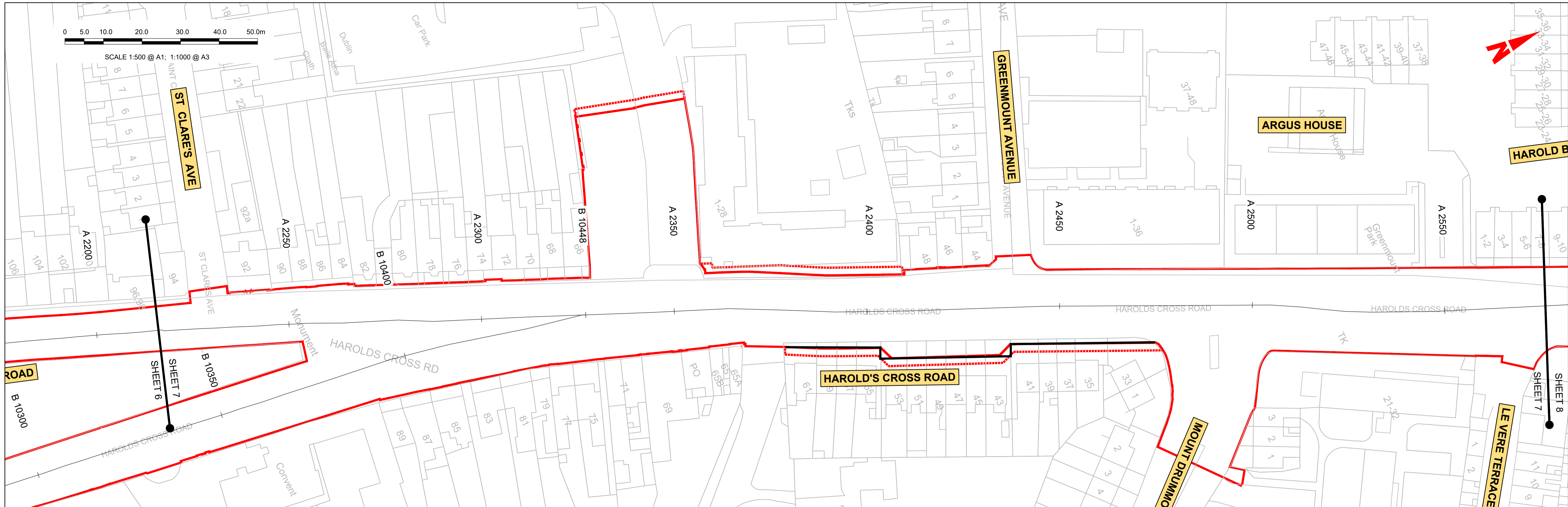

GEO_HV-0011_ML_00-M3-CR-0001-A01
SCALE: H 1:500, V 1:100

Disclaimer
 a. © National Transport Authority (NTA) 2022. This drawing is confidential and the copyright in it is owned by NTA. This drawing must not be either loaned, copied or otherwise reproduced in whole or in part or used for any purpose without the prior permission of NTA.
 b. This drawing is to be used for the design element identified in the titlebox. Other information shown is to be considered indicative only. The drawing is to be read in conjunction with all other relevant design drawings.
 c. O.S. data used for plans are printed under © Ordnance Survey Ireland Government of Ireland. All rights reserved. Licence Number 2022/OSI_NMA_180 National Transport Authority. All elevations are in metres and relate to OSI Geoid Model (OSGM15) Mean Head. All Co-ordinates are in Irish Transverse Mercator Grid (ITM) as defined by OSI active local GPS station.
 d. Information concerning the position of apparatus shown on this drawing is based on drawings supplied by the utility owners and/or the utility works contractor, whilst every care has been taken in the preparation of this drawing, positions should be taken as approximate and are intended for general guidance only and no representation is made by the NTA as to the accuracy, completeness, sufficiency or otherwise of this drawing and the position of the apparatus. The information contained herein does not purport to be comprehensive or final as the apparatus is subject to being altered and/or superceded. Recipients should not rely on this information. Any liabilities are hereby expressly disclaimed.
 e. The information contained herein has been provided by the NTA but does not purport to be comprehensive or final. Recipients should not rely on the information. Neither the NTA nor any of its directors, officers, employees, agents, stakeholders or advisers make any representation or warranty as to, or accept any liability or responsibility in relation to, the adequacy, accuracy, reasonableness or completeness of the information provided as part of this document or any matter on which the information is based (including but not limited to loss or damage arising as a result of reliance by recipients on the information or any part of it). Any liabilities are hereby expressly disclaimed.



Rev	Date	Drn	Chk'd	App'd	Description
M01	FEB 2023	CG	SMG	SMG	ISSUED FOR PHASE 4: PLANNING

Client: **NTA**
Údarás Náisiúnta Iompair
National Transport Authority

Engineering Designer: **CIROD**
TYPSA

Date: FEB 2023 | Scale: 1:500 @ A1, 1:1,000 @ A3 | Drawn: CG | Checked: SMG | Approved: SMG

Programme Code: BCIDD | Originator Code: ROT | QMS Code:

Programme Title: BUSCONNECTS DUBLIN CORE BUS CORRIDORS INFRASTRUCTURE WORKS			
Drawing Title: KIMMAGE TO CITY CENTRE CORE BUS CORRIDOR SCHEME MAINLINE PLAN & PROFILES			
Drawing File Name: BCIDD-ROT-GEO_HV-0011_ML_00-DR-CR-0007	Sheet Number: 07 of 11	Status: A	Rev: M01

\\nodubp1u20191917119117-02_WIP008 MODELS01 CAD01 DWG003 STG 3 - STATUTORY PROCESS (M)01 PLANNING11 KIMMAGEBCIDD-ROT-GEO_HV-0011_ML_00-DR-CR-0001.dwg

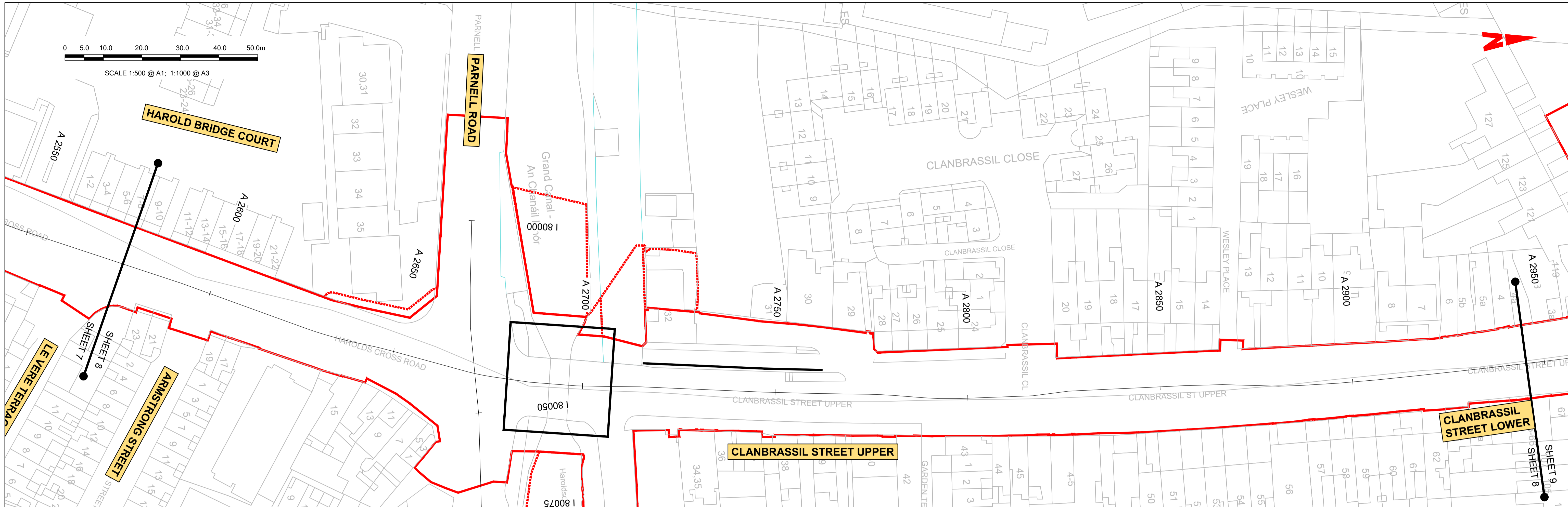

LEGEND:

- PROPOSED GROUND PROFILE
- - - EXISTING GROUND PROFILE
- SITE BOUNDARY LINE
- - - TEMPORARY LAND ACQUISITION

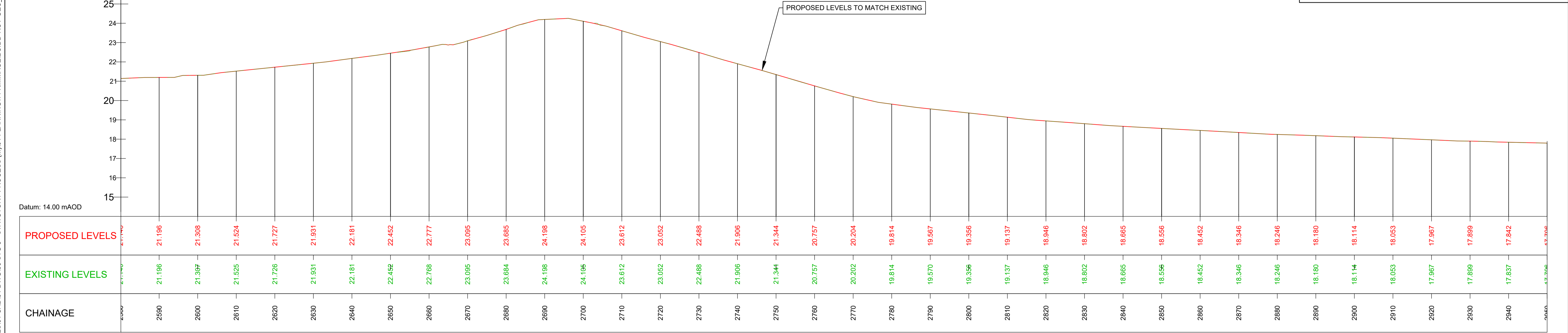

GEO_HV-0011_ML_00-M3-CR-0001-A01
SCALE: H 1:500, V 1:100

Disclaimer

a. © National Transport Authority (NTA) 2022. This drawing is confidential and the copyright in it is owned by NTA. This drawing must not be either loaned, copied or otherwise reproduced in whole or in part or used for any purpose without the prior permission of NTA.

b. This drawing is to be used for the design element identified in the titlebox. Other information shown is to be considered indicative only. The drawing is to be read in conjunction with all other relevant design drawings.

c. O.S. data used for plans are printed under © Ordnance Survey Ireland Government of Ireland. All rights reserved. Licence Number 2022/OSI_NMA_180 National Transport Authority. All elevations are in metres and relate to OSI Geoid Model (OSGM15) Mean Head. All Co-ordinates are in Irish Transverse Mercator Grid (ITM) as defined by OSI active local GPS station.

d. Information concerning the position of apparatus shown on this drawing is based on drawings supplied by the utility owners and/or the utility works contractor, whilst every care has been taken in the preparation of this drawing, positions should be taken as approximate and are intended for general guidance only and no representation is made by the NTA as to the accuracy, completeness, sufficiency or otherwise of this information. The information is subject to being altered and/or superseded. Recipients should not rely on this information. Any liabilities are hereby expressly disclaimed.

e. The information contained herein has been provided by the NTA but does not purport to be comprehensive or final. Recipients should not rely on the information. Neither the NTA nor any of its directors, officers, employees, agents, stakeholders or advisers make any representation or warranty as to, or accept any liability or responsibility in relation to, the adequacy, accuracy, reasonableness or completeness of the information provided as part of this document or any matter on which the information is based (including but not limited to loss or damage arising as a result of reliance by recipients on the information or any part of it). Any liabilities are hereby expressly disclaimed.



Rev	Date	Drn	Chk'd	App'd	Description
M01	FEB 2023	CG	SMG	SMG	ISSUED FOR PHASE 4: PLANNING

Client: **NTA**
Údarás Náisiúnta Iompair
National Transport Authority

Engineering Designer: **CIROD**
TYPSA

Date: FEB 2023 | Scale: 1:500 @ A1, 1:1,000 @ A3 | Drawn: CG | Checked: SMG | Approved: SMG

Programme Code: BCIDD | Originator Code: ROT | QMS Code:

Programme Title: **BUSCONNECTS DUBLIN**
CORE BUS CORRIDORS INFRASTRUCTURE WORKS

Drawing Title: KIMMAGE TO CITY CENTRE CORE BUS CORRIDOR SCHEME
MAINLINE PLAN & PROFILES

Drawing File Name: BCIDD-ROT-GEO_HV-0011_ML_00-DR-CR-0008 | Sheet Number: 08 of 11 | Status: A | Rev: M01

DO NOT SCALE USE FIGURED DIMENSIONS ONLY

\\nodubp1\U201919\1719117-02_WIP08 MODELS\01 CAD\01 DWG\03 STG 3 - STATUTORY PROCESS (M)\01 PLANNING\11 KIMMAGE\BCIDD-ROT-GEO_HV-0011_ML_00-DR-CR-0001.dwg

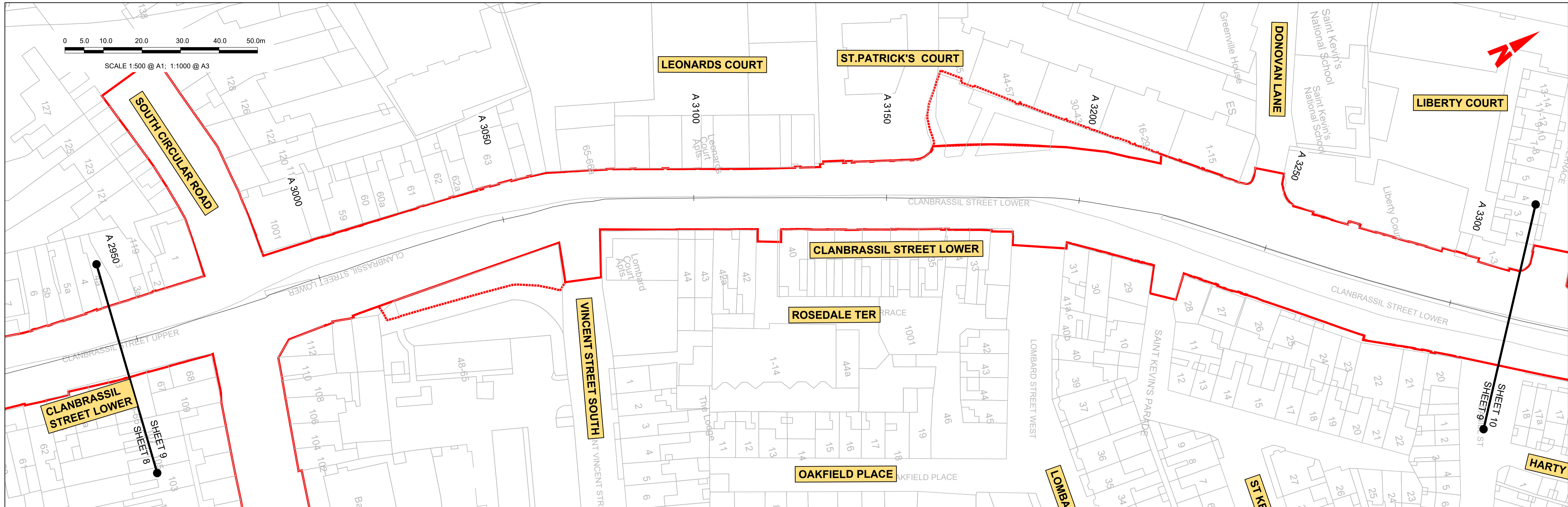

LEGEND:

- PROPOSED GROUND PROFILE
- - - EXISTING GROUND PROFILE
- SITE BOUNDARY LINE
- - - TEMPORARY LAND ACQUISITION

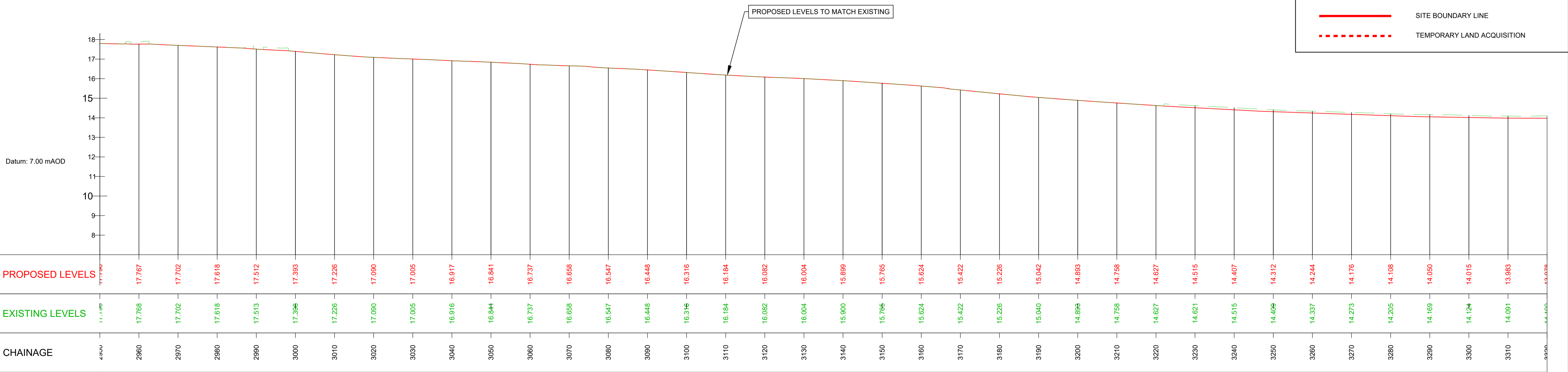

GEO_HV-0011_ML_00-M3-CR-0001-A01
SCALE: H 1:500, V 1:100

Disclaimer:

a. © National Transport Authority (NTA) 2022. This drawing is confidential and the copyright in it is owned by NTA. This drawing must not be either loaned, copied or otherwise reproduced in whole or in part or used for any purpose without the prior permission of NTA.

b. This drawing is to be used for the design element identified in the titlebox. Other information shown is to be considered indicative only. The drawing is to be read in conjunction with all other relevant design drawings.

c. O.S. data used for plans are printed under © Ordnance Survey Ireland Government of Ireland. All rights reserved. Licence Number 2022/OSI_NMA_180 National Transport Authority. All elevations are in metres and relate to OSI Geoid Model (OSGM15) Mean Head. All Co-ordinates are in Irish Transverse Mercator Grid (ITM) as defined by OSI active local GPS station.

d. Information concerning the position of apparatus shown on this drawing is based on drawings supplied by the utility owners and/or the utility works contractor, whilst every care has been taken in the preparation of this drawing, positions should be taken as approximate and are intended for general guidance only and no representation is made by the NTA as to the accuracy, completeness, sufficiency or otherwise of this information. The information contained herein does not purport to be comprehensive or final as the apparatus is subject to being altered and/or superceded. Recipients should not rely on this information. Any liabilities are hereby expressly disclaimed.

e. The information contained herein has been provided by the NTA but does not purport to be comprehensive or final. Recipients should not rely on the information. Neither the NTA nor any of its directors, officers, employees, agents, stakeholders or advisers make any representation or warranty as to, or accept any liability or responsibility in relation to, the adequacy, accuracy, reasonableness or completeness of the information provided as part of this document or any matter on which the information is based (including but not limited to loss or damage arising as a result of reliance by recipients on the information or any part of it). Any liabilities are hereby expressly disclaimed.

Rev	Date	Drn	Chk'd	App'd	Description
M01	FEB 2023	CG	SMG	SMG	ISSUED FOR PHASE 4: PLANNING

Client
NTA
Údarás Náisiúnta Iompair
National Transport Authority

Engineering Designer
IROD
TYPSA

Date: FEB 2023
Scale: 1:500 @ A1, 1:1,000 @ A3
Drawn: CG
Checked: SMG
Approved: SMG

Programme Code: BCIDD
Originator Code: ROT
QMS Code:

Programme Title
BUSCONNECTS DUBLIN
CORE BUS CORRIDORS INFRASTRUCTURE WORKS

Drawing Title
KIMMAGE TO CITY CENTRE CORE BUS CORRIDOR SCHEME
MAINLINE PLAN & PROFILES

Drawing File Name: BCIDD-ROT-GEO_HV-0011_ML_00-DR-CR-0009
Sheet Number: 09 of 11
Status: A
Rev: M01

DO NOT SCALE USE FIGURED DIMENSIONS ONLY

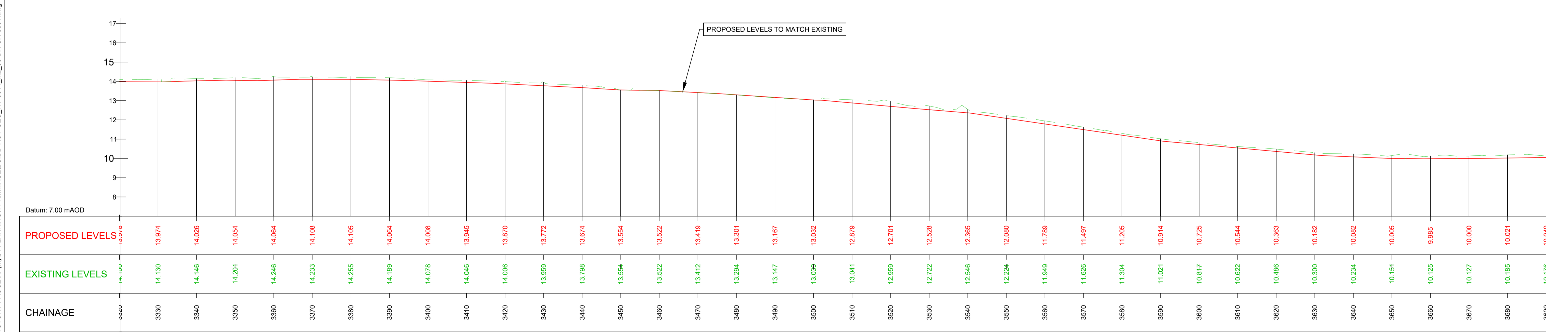
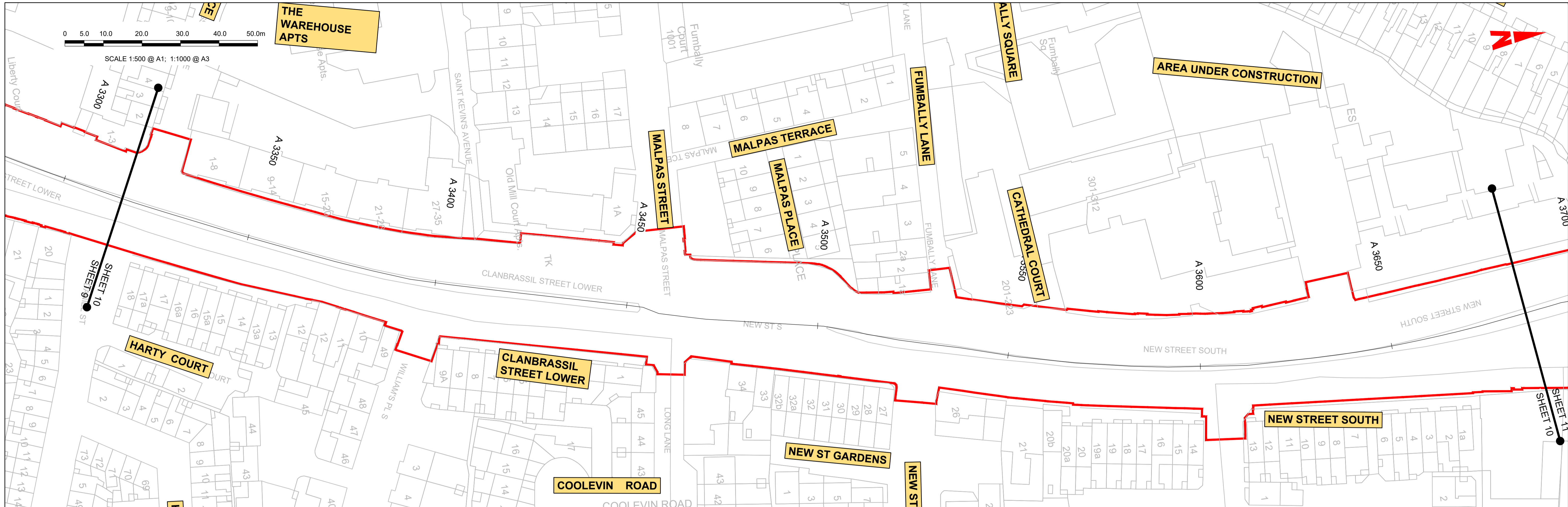

GEO_HV-0011_ML_00-M3-CR-0001-A01
SCALE: H 1:500, V 1:100

LEGEND:

- PROPOSED GROUND PROFILE
- - - EXISTING GROUND PROFILE
- SITE BOUNDARY LINE
- - - - - TEMPORARY LAND ACQUISITION

Disclaimer

a. © National Transport Authority (NTA) 2022. This drawing is confidential and the copyright in it is owned by NTA. This drawing must not be either loaned, copied or otherwise reproduced in whole or in part or used for any purpose without the prior permission of NTA.

b. This drawing is to be used for the design element identified in the titleblock. Other information shown is to be considered indicative only. The drawing is to be read in conjunction with all other relevant design drawings.

c. O.S. data used for plans are printed under © Ordnance Survey Ireland Government of Ireland. All rights reserved. Licence Number 2022/OSI_NMA_180 National Transport Authority. All elevations are in metres and relate to OSI Geoid Model (OSGM15) Mean Head. All Co-ordinates are in Irish Transverse Mercator Grid (ITM) as defined by OSI active local GPS station.

d. Information concerning the position of apparatus shown on this drawing is based on drawings supplied by the utility owners and/or the utility works contractor, whilst every care has been taken in the preparation of this drawing, positions should be taken as approximate and are intended for general guidance only and no representation is made by the NTA as to the accuracy, completeness, sufficiency or otherwise of this drawing and the position of the apparatus. The information contained herein does not purport to be comprehensive or final as the apparatus is subject to being altered and/or superceded. Recipients should not rely on this information. Any liabilities are hereby expressly disclaimed.

e. The information contained herein has been provided by the NTA but does not purport to be comprehensive or final. Recipients should not rely on the information. Neither the NTA nor any of its directors, officers, employees, agents, stakeholders or advisers make any representation or warranty as to, or accept any liability or responsibility in relation to, the adequacy, accuracy, reasonableness or completeness of the information provided as part of this document or any matter on which the information is based (including but not limited to loss or damage arising as a result of reliance by recipients on the information or any part of it). Any liabilities are hereby expressly disclaimed.

Rev	Date	Drn	Chk'd	App'd	Description
M01	FEB 2023	CG	SMG	SMG	ISSUED FOR PHASE 4: PLANNING

<p>Údarás Náisiúnta Iompair National Transport Authority</p>		<p>Engineering Designer</p>		
Date	Scale	Drawn	Checked	Approved
FEB 2023	1:500 @ A1 1:1,000 @ A3	CG	SMG	SMG
Programme Code	Originator Code	QMS Code		
BCIDD	ROT			

<p>Programme Title</p> <p>BUSCONNECTS DUBLIN CORE BUS CORRIDORS INFRASTRUCTURE WORKS</p>			
<p>Drawing Title</p> <p>KIMMAGE TO CITY CENTRE CORE BUS CORRIDOR SCHEME MAINLINE PLAN & PROFILES</p>			
Drawing File Name	Sheet Number	Status	Rev
BCIDD-ROT-GEO_HV-0011_ML_00-DR-CR-0010	10 of 11	A	M01

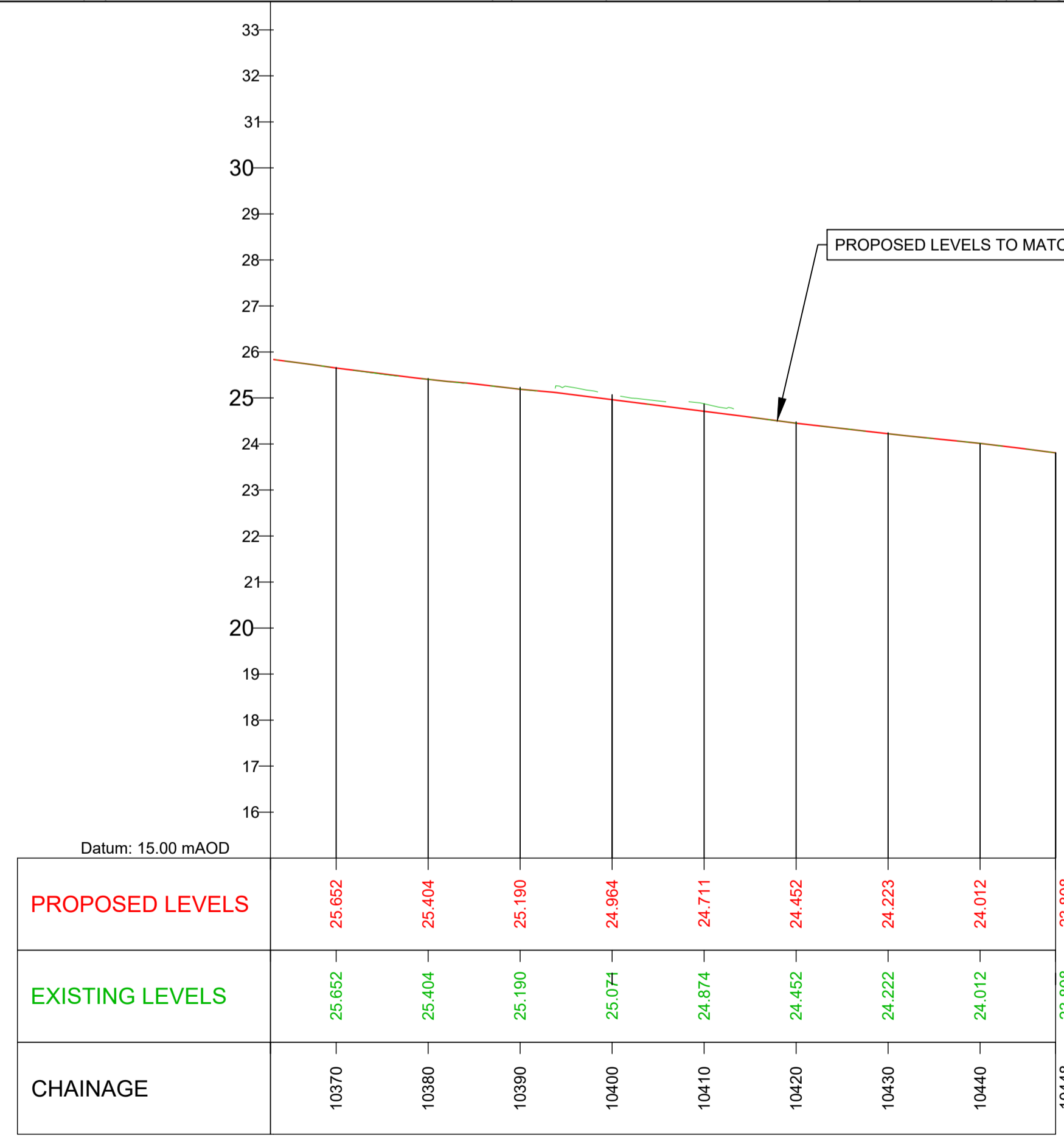
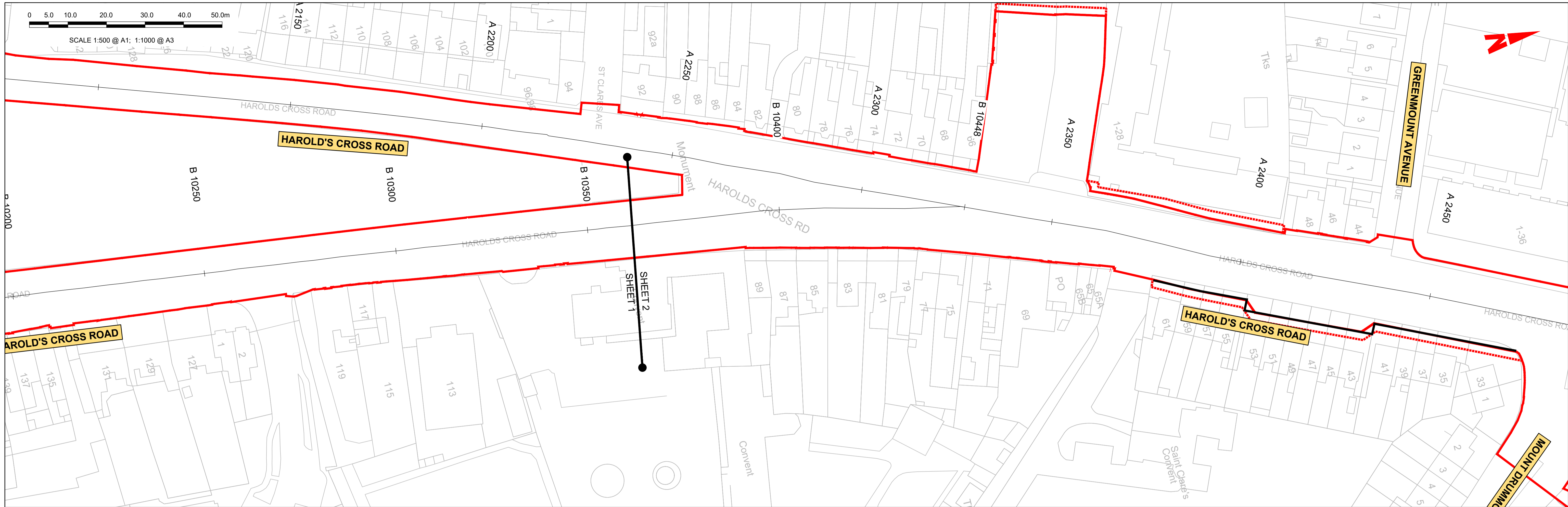

LEGEND:

- PROPOSED GROUND PROFILE
- - - EXISTING GROUND PROFILE
- SITE BOUNDARY LINE
- - - - - TEMPORARY LAND ACQUISITION

GEO_HV-0011_ML_00-M3-CR-0001-A02
SCALE: H 1:500, V 1:100

\\nodubp1\U201917\17117-02_WIP\08 MODELS\01 CAD\01 DWG\03 STG 3 - STATUTORY PROCESS (M)\01 PLANNING\11 KIMMAGE\BCIDD-ROT-GEO_HV-0011_SR_00-DR-CR-0001.dwg

Disclaimer

a. © National Transport Authority (NTA) 2022. This drawing is confidential and the copyright in it is owned by NTA. This drawing must not be either loaned, copied or otherwise reproduced in whole or in part or used for any purpose without the prior permission of NTA.

b. This drawing is to be used for the design element identified in the titleblock. Other information shown is to be considered indicative only. The drawing is to be read in conjunction with all other relevant design drawings.

c. O.S. data used for plans are printed under © Ordnance Survey Ireland Government of Ireland. All rights reserved. Licence Number 2022/OSI_NMA_180 National Transport Authority. All elevations are in metres and relate to OSI Geoid Model (OSGM15) Mean Head. All Co-ordinates are in Irish Transverse Mercator Grid (ITM) as defined by OSI active local GPS station.

d. Information concerning the position of apparatus shown on this drawing is based on drawings supplied by the utility owners and/or the utility works contractor, whilst every care has been taken in the preparation of this drawing, positions should be taken as approximate and are intended for general guidance only and no representation is made by the NTA as to the accuracy, completeness, sufficiency or otherwise of this drawing and the position of the apparatus. The information contained herein does not purport to be comprehensive or final as the apparatus is subject to being altered and/or superceded. Recipients should not rely on this information. Any liabilities are hereby expressly disclaimed.

e. The information contained herein has been provided by the NTA but does not purport to be comprehensive or final. Recipients should not rely on the information. Neither the NTA nor any of its directors, officers, employees, agents, stakeholders or advisers make any representation or warranty as to, or accept any liability or responsibility in relation to, the adequacy, accuracy, reasonableness or completeness of the information provided as part of this document or any matter on which the information is based (including but not limited to loss or damage arising as a result of reliance by recipients on the information or any part of it). Any liabilities are hereby expressly disclaimed.

Rev	Date	Drn	Chk'd	App'd	Description
M01	FEB 2023	CG	EOC	SMG	ISSUED FOR PHASE 4: PLANNING

Client

Engineering Designer

Drawn	Checked	Approved
CG	EOC	SMG

Programme Title

**BUSCONNECTS DUBLIN
CORE BUS CORRIDORS INFRASTRUCTURE WORKS**

Drawing Title

KIMMAGE TO CITY CENTRE CORE BUS CORRIDOR SCHEME
SIDEROAD PLAN & PROFILES

Drawing File Name	Sheet Number	Status	Rev
BCIDD-ROT-GEO_HV-0011_SR_00-DR-CR-0002	02 of 03	A	M01

DO NOT SCALE USE FIGURED DIMENSIONS ONLY

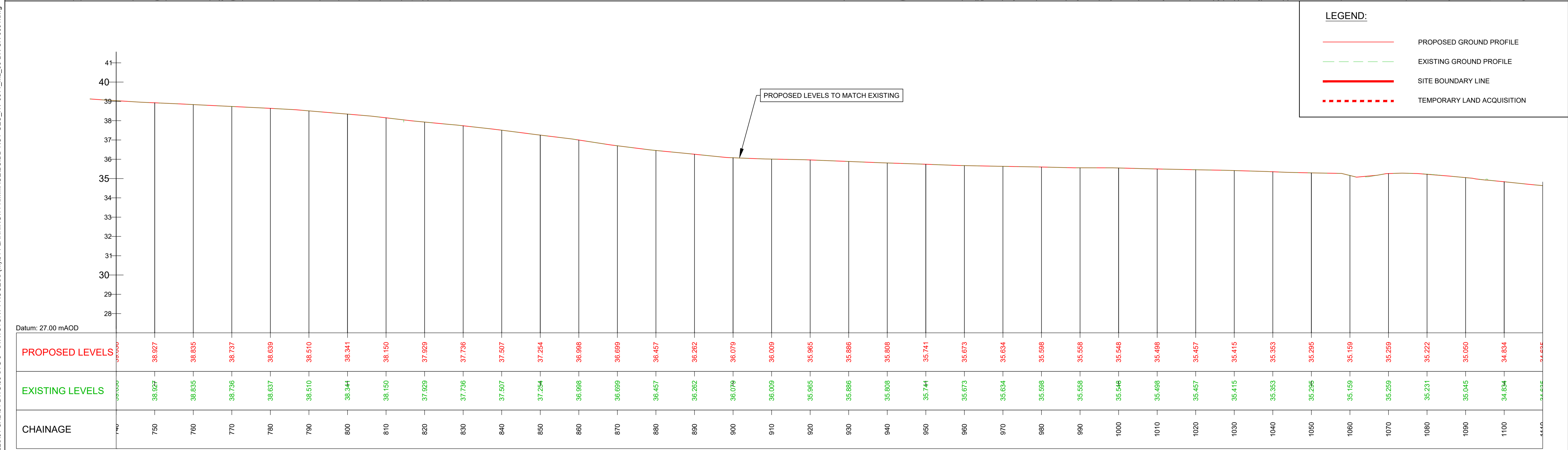
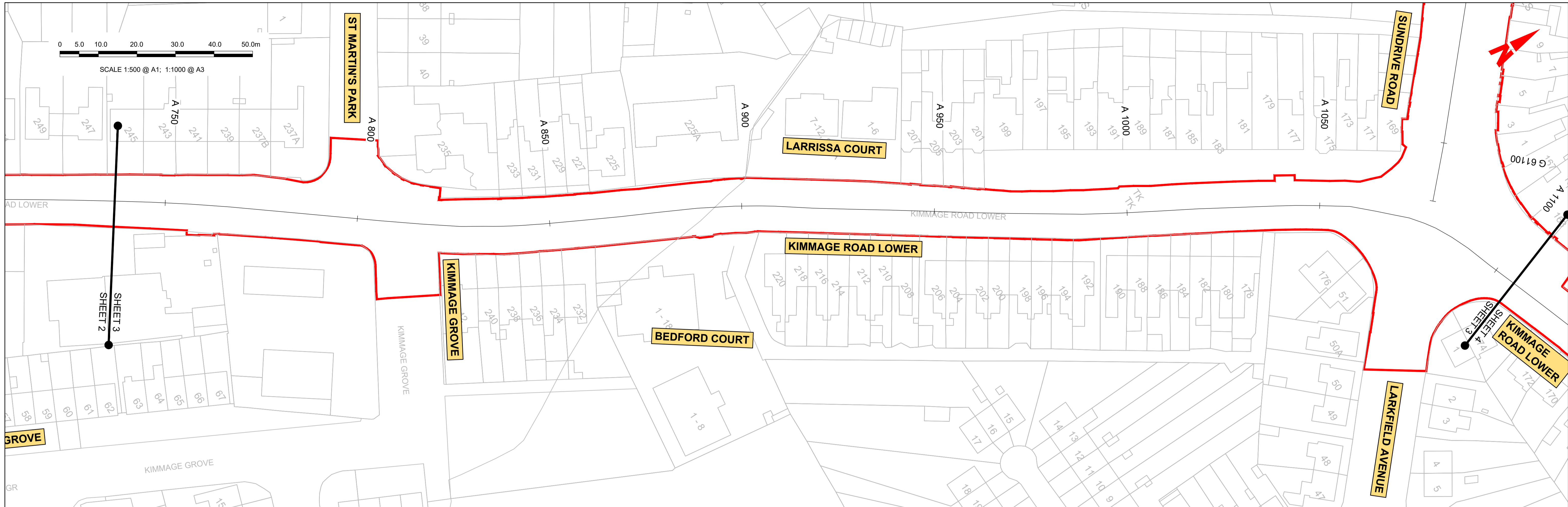

GEO_HV-0011_ML_00-M3-CR-0001-A01
SCALE: H 1:500,V 1:100

LEGEND:

- PROPOSED GROUND PROFILE
- - - EXISTING GROUND PROFILE
- SITE BOUNDARY LINE
- - - - - TEMPORARY LAND ACQUISITION

Disclaimer:
 a. © National Transport Authority (NTA) 2022. This drawing is confidential and the copyright in it is owned by NTA. This drawing must not be either loaned, copied or otherwise reproduced in whole or in part or used for any purpose without the prior permission of NTA.
 b. This drawing is to be used for the design element identified in the titlebox. Other information shown is to be considered indicative only. The drawing is to be read in conjunction with all other relevant design drawings.
 c. O.S. data used for plans are printed under © Ordnance Survey Ireland Government of Ireland. All rights reserved. Licence Number 2022/OSI_NMA_180 National Transport Authority. All elevations are in metres and relate to OSI Geoid Model (OSGM15) Malin Head. All Co-ordinates are in Irish Transverse Mercator Grid (ITM) as defined by OSI active local GPS station.
 d. Information concerning the position of apparatus shown on this drawing is based on drawings supplied by the utility owners and/or the utility works contractor, whilst every care has been taken in the preparation of this drawing, positions should be taken as approximate and are intended for general guidance only and no representation is made by the NTA as to the accuracy, completeness, sufficiency or otherwise of this drawing and the position of the apparatus. The information contained herein does not purport to be comprehensive or final as the apparatus is subject to being altered and/or superceded. Recipients should not rely on this information. Any liabilities are hereby expressly disclaimed.
 e. The information contained herein has been provided by the NTA but does not purport to be comprehensive or final. Recipients should not rely on the information. Neither the NTA nor any of its directors, officers, employees, agents, stakeholders or advisers make any representation or warranty as to, or accept any liability or responsibility in relation to, the adequacy, accuracy, reasonableness or completeness of the information provided as part of this document or any matter on which the information is based (including but not limited to loss or damage arising as a result of reliance by recipients on the information or any part of it). Any liabilities are hereby expressly disclaimed.

Rev	Date	Drn	Chk'd	App'd	Description
M01	FEB 2023	CG	SMG	SMG	ISSUED FOR PHASE 4: PLANNING

Client: **NTA**
 Údarás Náisiúnta Iompair
 National Transport Authority

Engineering Designer: **CIROD**
 TYPSA

Date: FEB 2023
 Scale: 1:500 @ A1, 1:1,000 @ A3

Drawn: CG
 Checked: SMG
 Approved: SMG

Programme Code: BCIDD
 Originator Code: ROT
 QMS Code:

Programme Title: **BUSCONNECTS DUBLIN**
CORE BUS CORRIDORS INFRASTRUCTURE WORKS

Drawing Title: **KIMMAGE TO CITY CENTRE CORE BUS CORRIDOR SCHEME**
 MAINLINE PLAN & PROFILES

Drawing File Name: BCIDD-ROT-GEO_HV-0011_ML_00-DR-CR-0003
 Sheet Number: 03 of 11
 Status: A
 Rev: M01

DO NOT SCALE USE FIGURED DIMENSIONS ONLY

\\vodubp1u201919171719117-02_WIP08 MODELS01 CAD01 DWG03 STG 3 - STATUTORY PROCESS (M)01 PLANNING11 KIMMAGE\BCIDD-ROT-GEO_HV-0011_ML_00-DR-CR-0001.dwg